



# WALK-IN HOOD

# F-200 Gen-5 Floor Mounted Fume Hood

## F-200 Gen-5 Floor Mounted Fume Hood - Frameless Vertical Sash

ISOLATOR Gen-5 Floor Mounted Fume Hood - This general purpose fume hood is designed to meet most laboratory Constant Air Volume (CAV) or Variable Air Volume (VAV) requirements and supplied with and automatic compensating upper by-pass. For VAV, use option MOD-0004 for a restricted by-pass position of observation glass. Designed to be used with or without an epoxy floor. The ISOLATOR Gen-5 floor mounted fume hood is supplied with the following standard features:

**Counter Balance Systems** - Chain and sprocket system delivers the easiest and most reliable sash operation available with an exceptional product life-cycle ISOLATOR drive system provides economical and reliable operation; tested to over 1 million cycles with no failure.

**Sash Design** - 1/4" thick tempered safety glass is provided with an epoxy urethane coated steel handles. Optional laminated safety glass or polycarbonate available for special applications. Hood has a frameless vertical sash with a superior exterior sightline.

**Stainless Steel Type 304 Exhaust Collar** - Round collar which allows for direct connection to typical exhaust ducts to reduce duct transition costs, minimize static pressure losses and exhaust noise levels.

**Electrical** - Two UL/CSA approved duplex receptacles provided for 120 volt service, one on each corner post. UL/CSA approved LED light fixture and switch provided. Explosion proof fixtures are available options.

**Plumbing** - Both corner posts are pre-punched to accept a maximum of five plumbing fittings per post. Factory pre-plumbing is available as well as plumbing fixtures from a variety of manufacturers to meet most plumbing needs.

**Access Panels** - Interior overlay style access panels provide convenient access and prevent accidental removal. Exterior side panels are also removable for ease of access to plumbing and electrical service fixtures.

**Standards** - UL 1805 Classified and tested in accordance with ASHRAE 110. Test results available upon request.



Rendering shown with optional features

Catalog Number	Width	Clear Interior Depth	Duct Diameter	31 1/2" Vertical Open Upper Sash @ 100 FPM	18" Vertical Open Upper Sash @ 100 FPM
F-200-48G5	48"	24"	1:10"	858 CFM @ .39" SP	501 CFM @ .13" SP
F-200-48G5D30	48"	30"	1:10"	858 CFM @ .39" SP	501 CFM @ .13" SP
F-200-60G5	60"	24"	1:12"	1128 CFM @ .37" SP	660 CFM @ .13" SP
F-200-60G5D30	60"	30"	1:12"	1128 CFM @ .37" SP	660 CFM @ .13" SP
F-200-72G5	72"	24"	1:12"	1399 CFM @ .57" SP	818 CFM @ .19" SP
F-200-72G5D30	72"	30"	1:12"	1399 CFM @ .57" SP	818 CFM @ .19" SP
F-200-96G5	96"	24"	2:10"	1941 CFM @ .50" SP	1135 CFM @ .17" SP
F-200-96G5D30	96"	30"	2:10"	1941 CFM @ .50" SP	1135 CFM @ .17" SP

# F-200 Gen-5 Floor Mounted Fume Hood

**F-200-48G5 - 48" Wide**

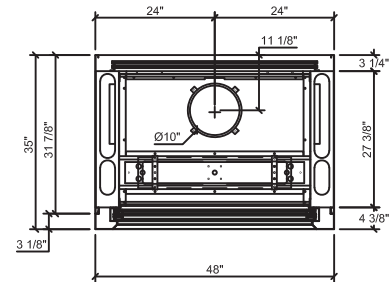
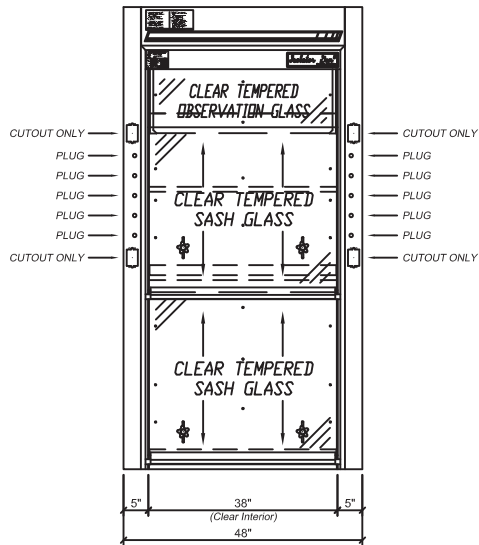

**F-200-60G5 - 60" Wide**

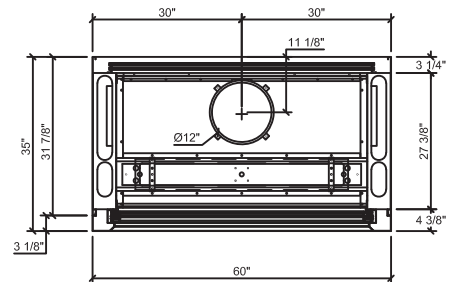
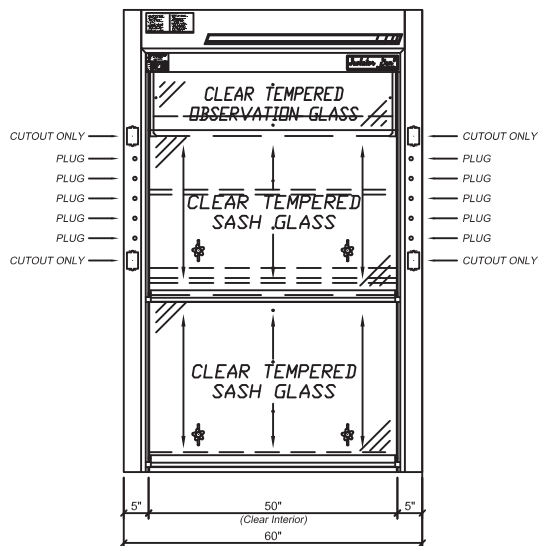

**F-200-72G5 - 72" Wide**

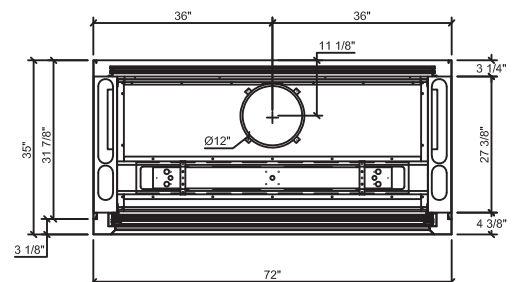
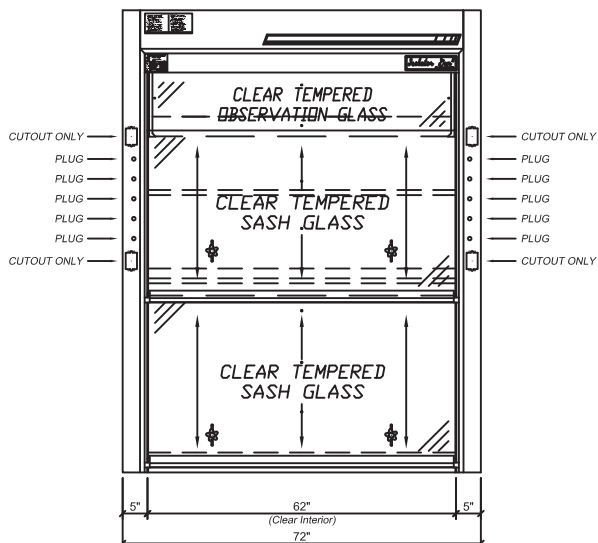

# F-200 Gen-5 Floor Mounted Fume Hood

## F-200-96G5 - 96" Wide

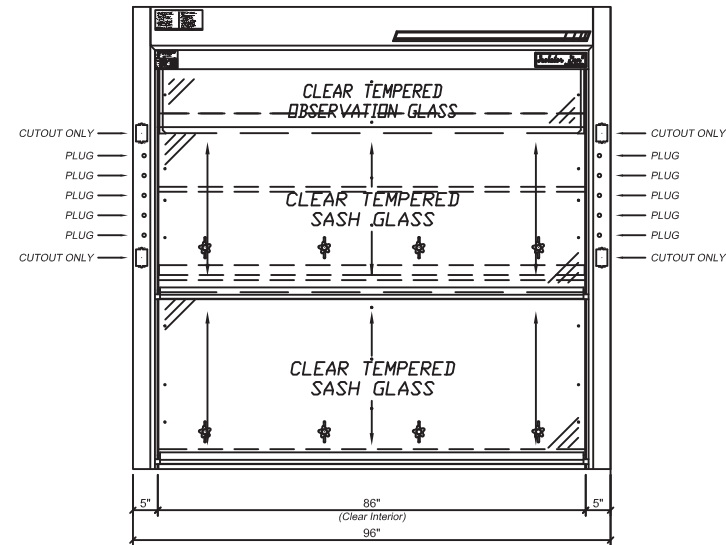

Section - Standard Depth

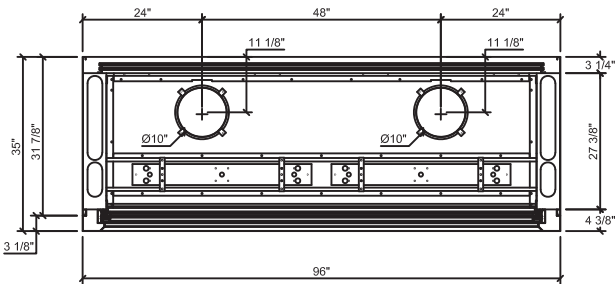

Section - 30" Deep

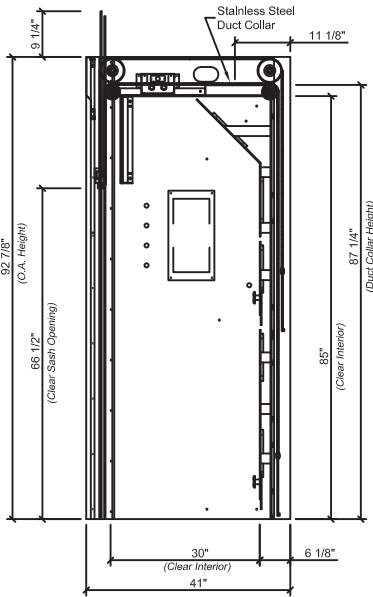
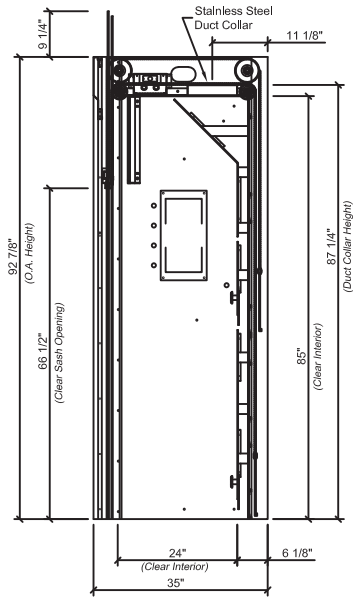

# F-201 Gen-5 Floor Mounted Fume Hood

## F-201 Isolator Gen-5 Floor Mounted Fume Hood - Combination Sash

ISOLATOR Gen-5 Floor Mounted Fume Hood - This general purpose fume hood is designed to meet most laboratory Constant Air Volume (CAV) or Variable Air Volume (VAV) requirements and supplied with and automatic compensating upper by-pass. For VAV, use option MOD-0004 for a restricted by-pass position of observation glass. Designed to be used with or without an epoxy floor.

The ISOLATOR Gen-5 floor mounted fume hood is supplied with the following standard features:

**Counter Balance Systems** - Chain and sprocket system delivers the easiest and most reliable sash operation available with an exceptional product life-cycle ISOLATOR drive system provides economical and reliable operation; tested to over 1 million cycles with no failure.

**Sash Design** - 1/4" thick tempered safety glass is provided with an stainless steel frame. Optional laminated safety glass or polycarbonate available for special applications. Hood has one combination and one framed vertical sash with a superior exterior sightline.

**Stainless Steel Type 304 Exhaust Collar** - Round collar which allows for direct connection to typical exhaust ducts to reduce duct transition costs, minimize static pressure losses and exhaust noise levels.

**Electrical** - Two UL/CSA approved duplex receptacles provided for 120 volt service, one on each corner post. UL/CSA approved LED light fixture and switch provided. Explosion proof fixtures are available options.

**Plumbing** - Both corner posts are pre-punched to accept a maximum of five plumbing fittings per post. Factory pre-plumbing is available as well as plumbing fixtures from a variety of manufacturers to meet most plumbing needs.

**Access Panels** - Interior overlay style access panels provide convenient access and prevent accidental removal. Exterior side panels are also removable for ease of access to plumbing and electrical service fixtures.

**Standards** - UL 1805 Classified and tested in accordance with ASHRAE 110. Test results available upon request.



Rendering shown with optional features

Catalog Number	Width	Clear Interior Depth	Duct Diameter	31 1/2" Vertical Open Upper Sash @ 100 FPM	18" Vertical Open @ 100 FPM	50% Open @ 100 FPM
F-201-48G5	48"	24"	1:10"	858 CFM @ .39" SP	501 CFM @ .13" SP	444 CFM @ .10" SP
F-201-48G5D30	48"	30"	1:10"	858 CFM @ .39" SP	501 CFM @ .13" SP	444 CFM @ .10" SP
F-201-60G5	60"	24"	1:12"	1128 CFM @ .37" SP	660 CFM @ .13" SP	586 CFM @ .10" SP
F-201-60G5D30	60"	30"	1:12"	1128 CFM @ .37" SP	660 CFM @ .13" SP	586 CFM @ .10" SP
F-201-72G5	72"	24"	1:12"	1399 CFM @ .57" SP	818 CFM @ .19" SP	739 CFM @ .16" SP
F-201-72G5D30	72"	30"	1:12"	1399 CFM @ .57" SP	818 CFM @ .19" SP	739 CFM @ .16" SP
F-201-96G5	96"	24"	2:10"	1941 CFM @ .50" SP	1135 CFM @ .17" SP	1035 CFM @ .14" SP
F-201-96G5D30	96"	30"	2:10"	1941 CFM @ .50" SP	1135 CFM @ .17" SP	1035 CFM @ .14" SP
F-201-120G5	120"	24"	2:12"	2483 CFM @ .45" SP	1451 CFM @ 15" SP	1330 CFM @ .13" SP
F-201-120G5D30	120"	30"	2:12"	2483 CFM @ .45" SP	1451 CFM @ 15" SP	1330 CFM @ .13" SP
F-201-144G5	144"	24"	2:12"	3024 CFM @ .66" SP	1768 CFM @ 23" SP	1628 CFM @ .19" SP
F-201-144G5D30	144"	30"	2:12"	3024 CFM @ .66" SP	1768 CFM @ 23" SP	1628 CFM @ .19" SP

50% open may be achieved two ways: 1. vertical sash open 14", horizontal panels closed or 2. vertical sash closed, horizontal panels full open

# F-201 Gen-5 Floor Mounted Fume Hood

F-201-48G5 - 48" Wide

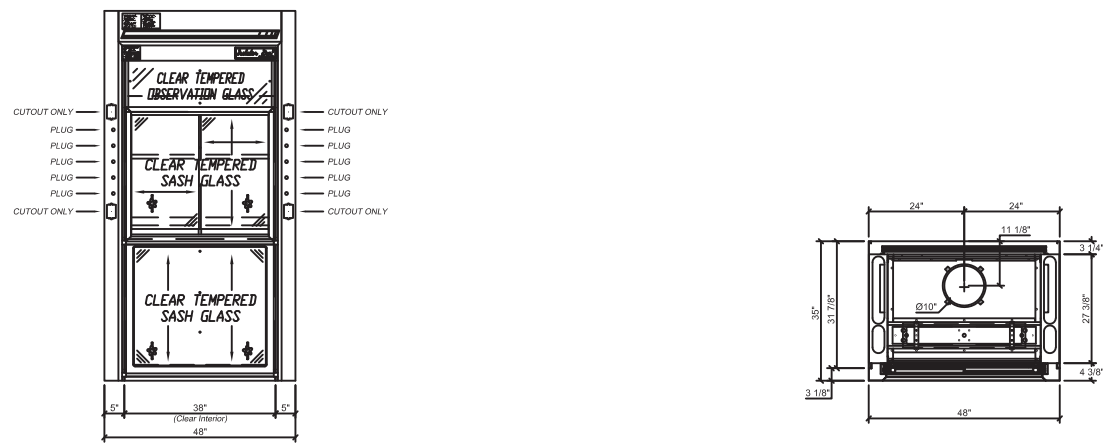

F-201-60G5 - 60" Wide

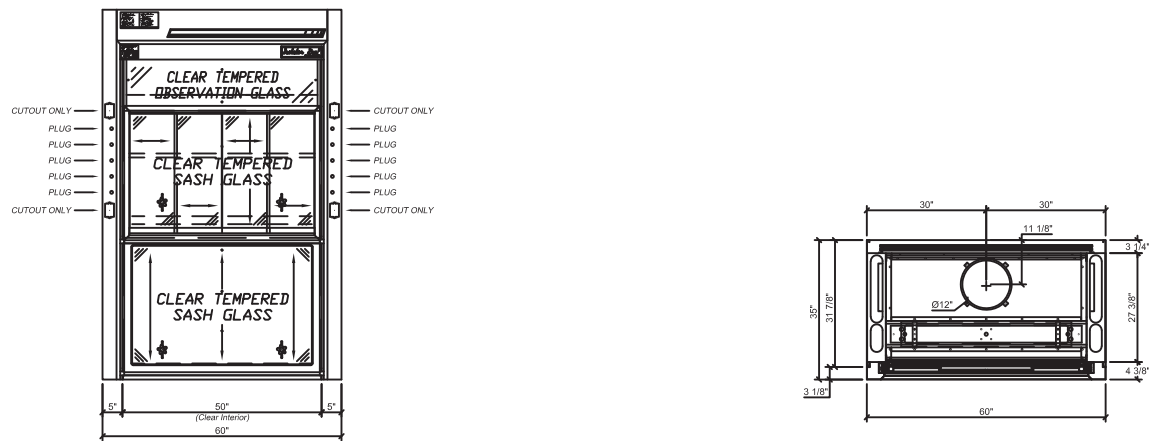

F-201-72G5 - 72" Wide

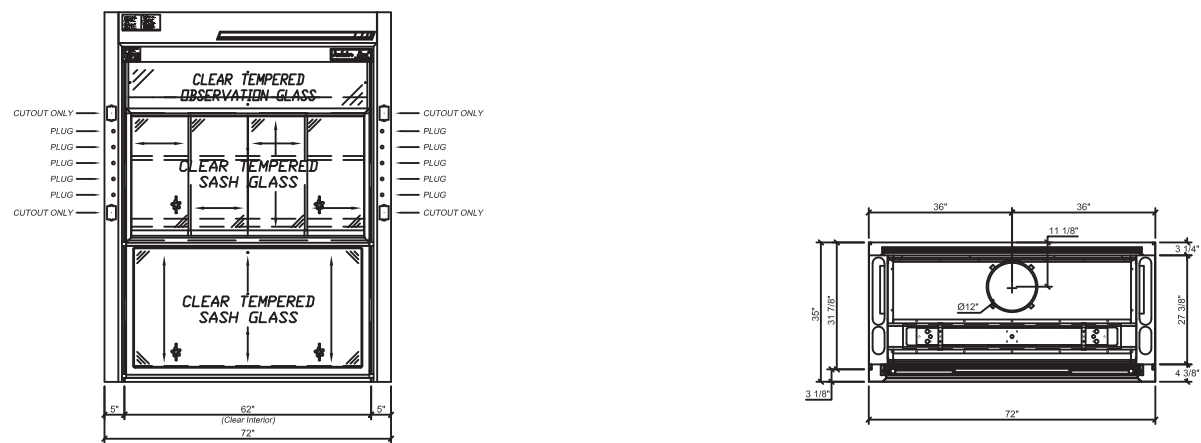



# F-201 Gen-5 Floor Mounted Fume Hood

**F-201-96G5 - 96" Wide**

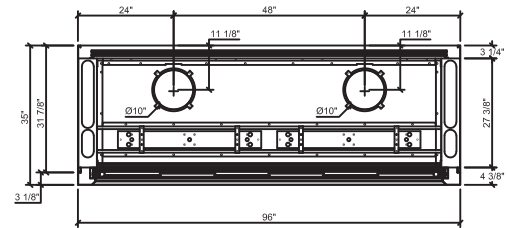
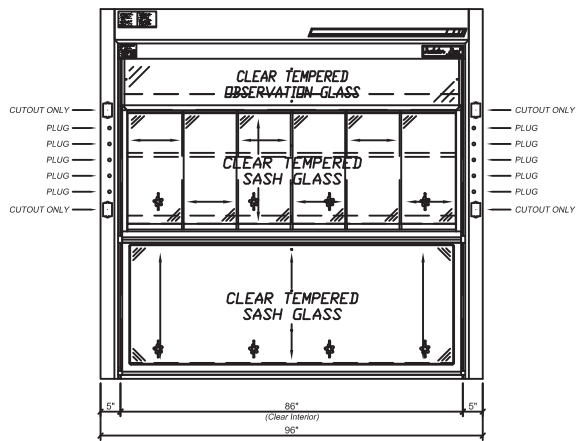

**F-201-120G5 - 120" Wide**

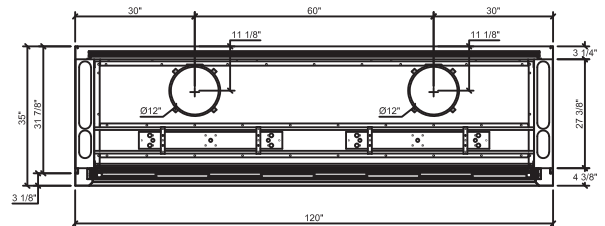
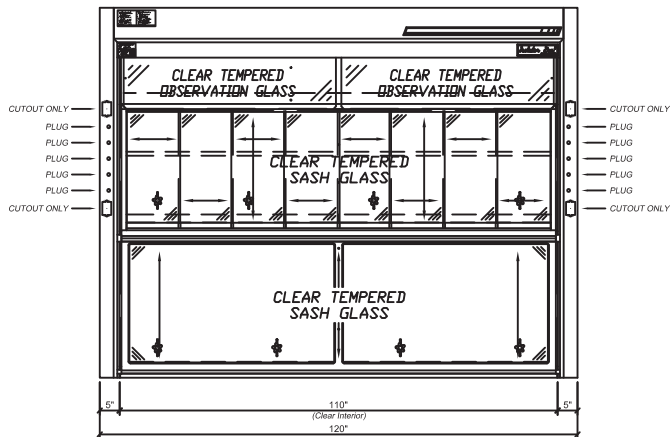

**F-201-144G5 - 144" Wide**

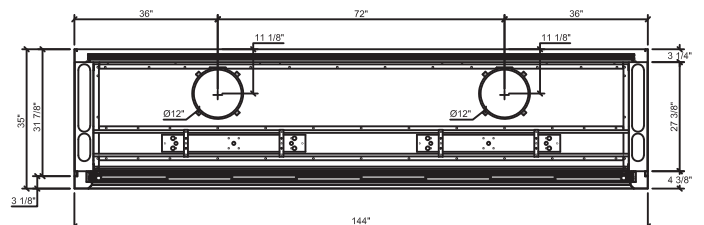
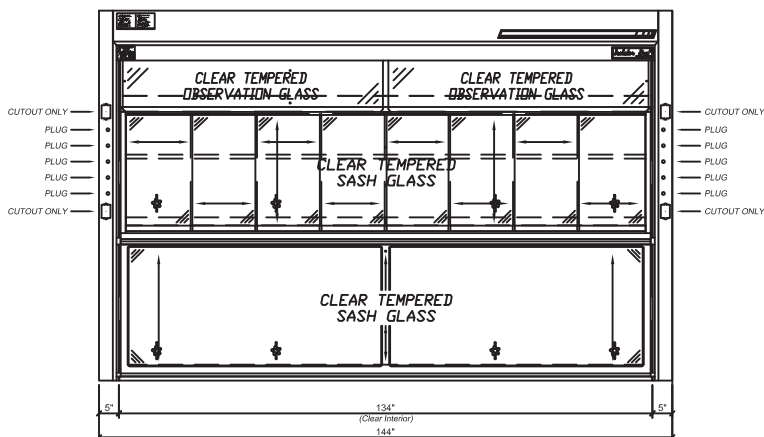

# F-201 Gen-5 Floor Mounted Fume Hood

Section - Standard Depth

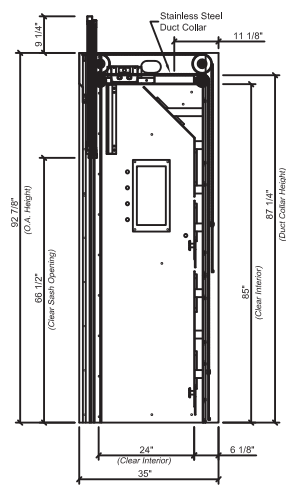

Section - 30" Deep

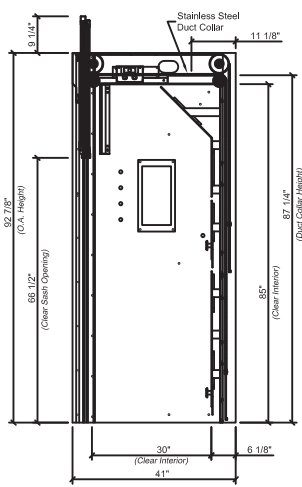



# F-202 Gen-5 Floor Mounted Fume Hood

## F-202 Isolator Gen-5 Floor Mounted Fume Hood - Horizontal Sash

ISOLATOR Gen-5 Floor Mounted Fume Hood - This general purpose fume hood is designed to meet most laboratory Constant Air Volume (CAV) or Variable Air Volume (VAV) requirements and supplied with and automatic compensating upper by-pass. For VAV, use option MOD-0004 for a restricted by-pass position of observation glass. Designed to be used with or without an epoxy floor. The ISOLATOR Gen-5 floor mounted fume hood is supplied with the following standard features:

**Track System** – Top hung roller bearing framed sashes offer an exceptional product life-cycle

**Sash Design** - 1/4" thick tempered safety glass is provided with epoxy urethane coated steel frames. Optional laminated safety glass or polycarbonate available for special applications. Hood has framed horizontal sashes with a superior exterior sightline.

**Stainless Steel Type 304 Exhaust Collar** - Round collar which allows for direct connection to typical exhaust ducts to reduce duct transition costs, minimize static pressure losses and exhaust noise levels.

**Electrical** - Two UL/CSA approved duplex receptacles provided for 120 volt service, one on each corner post. UL/CSA approved LED light fixture and switch provided. Explosion proof fixtures are available options.

**Plumbing** - Both corner posts are pre-punched to accept a maximum of five plumbing fittings per post. Factory pre-plumbing is available as well as plumbing fixtures from a variety of manufacturers to meet most plumbing needs.

**Access Panels** - Interior overlay style access panels provide convenient access and prevent accidental removal. Exterior side panels are also removable for ease of access to plumbing and electrical service fixtures.

**Standards** - UL 1805 Classified and tested in accordance with ASHRAE 110. Test results available upon request.



Rendering shown with optional features

Catalog Number	Width	Clear Interior Depth	Duct Diameter	31 1/2" Vertical Open Upper Sash @ 100 FPM	50% Horizontal Open @ 100 FPM
F-202-48G5	48"	24"	1:10"	N/A	907 CFM @ .43" SP
F-202-48G5D30	48"	30"	1:10"	N/A	907 CFM @ .43" SP
F-202-60G5	60"	24"	1:12"	N/A	1159 CFM @ .39" SP
F-202-60G5D30	60"	30"	1:12"	N/A	1159 CFM @ .39" SP
F-202-72G5	72"	24"	1:12"	N/A	1451 CFM @ .61" SP
F-202-72G5D30	72"	30"	1:12"	N/A	1451 CFM @ .61" SP
F-202-96G5	96"	24"	2:10"	N/A	1994 CFM @ .53" SP
F-202-96G5D30	96"	30"	2:10"	N/A	1994 CFM @ .53" SP
F-202-120G5	120"	24"	2:12"	N/A	2600 CFM @ .49" SP
F-202-120G5D30	120"	30"	2:12"	N/A	2600 CFM @ .49" SP
F-202-144G5	144"	24"	2:12"	N/A	3144 CFM @ .72" SP
F-202-144G5D30	144"	30"	2:12"	N/A	3144 CFM @ .72" SP

# F-202 Gen-5 Floor Mounted Fume Hood

F-202-48G5 - 48" Wide



F-202-60G5 - 60" Wide



F-202-72G5 - 72" Wide

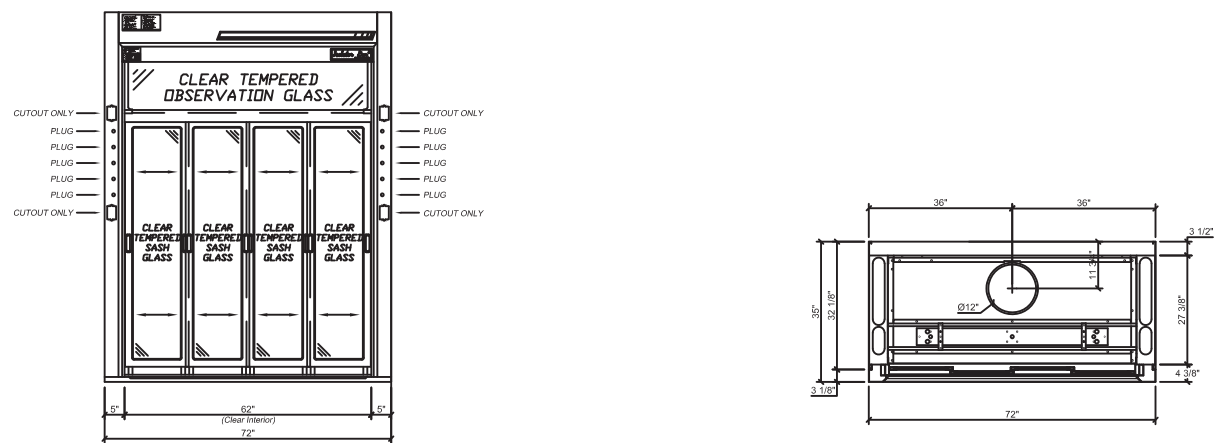

# F-202 Gen-5 Floor Mounted Fume Hood

**F-202-96G5 - 96" Wide**

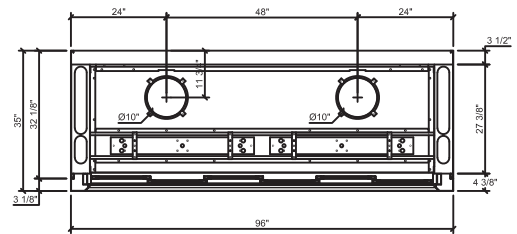
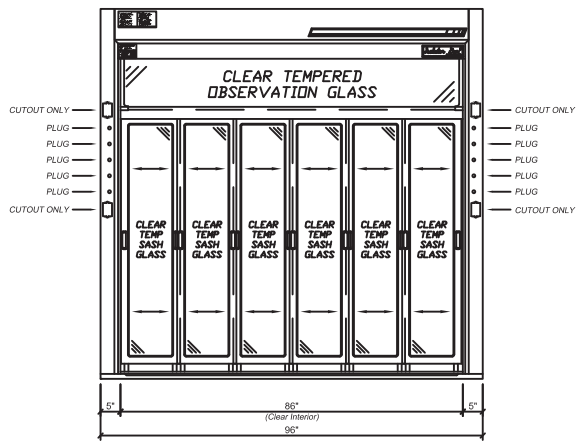

**F-202-120G5 - 120" Wide**

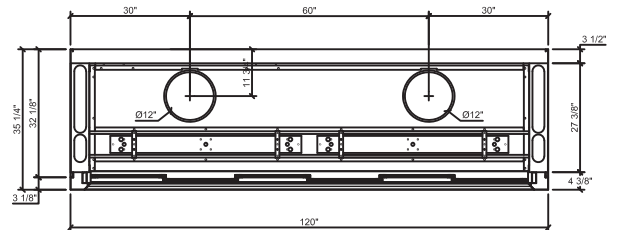
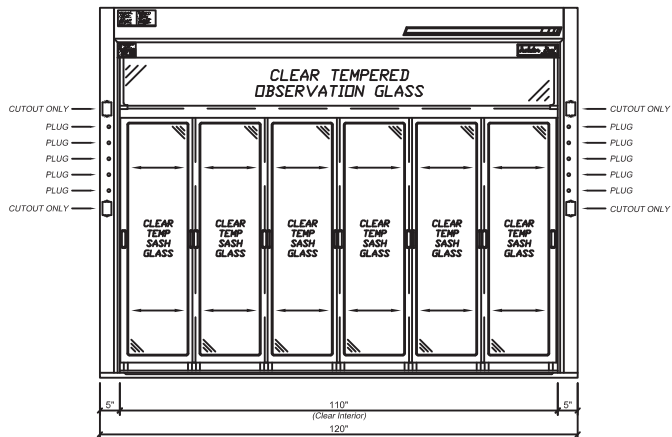

**F-202-144G5 - 144" Wide**

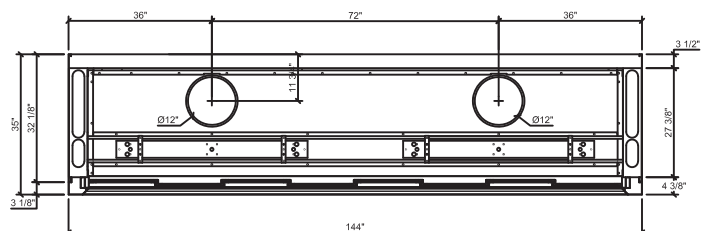
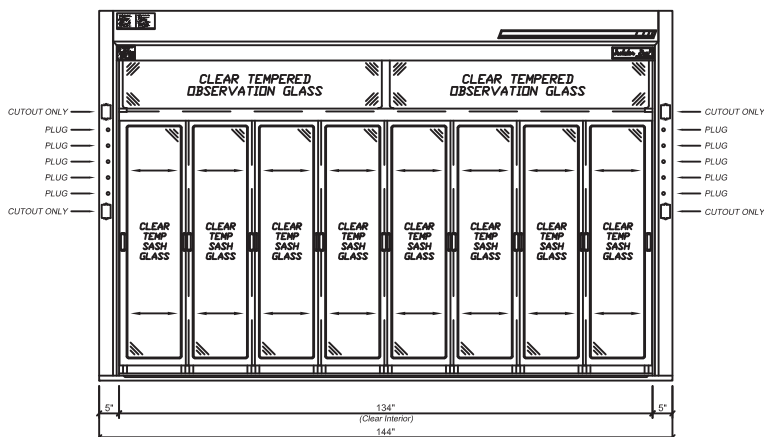

# F-202 Gen-5 Floor Mounted Fume Hood

Section - Standard Depth

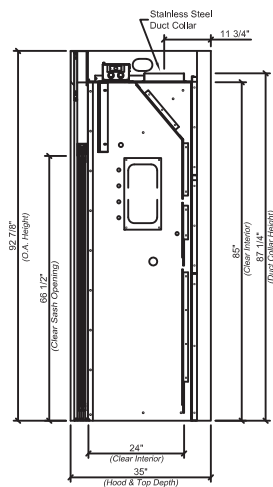

Section - 30" Deep

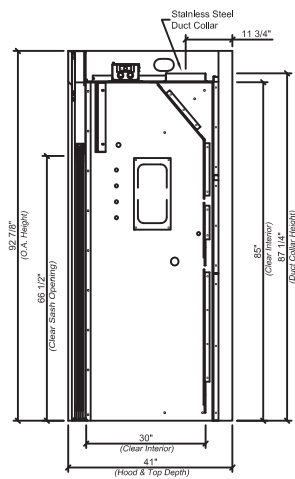

# F-203 Gen-5 Floor Mounted Fume Hood

## F-203 Isolator Gen-5 Floor Mounted Fume Hood - Framed Vertical Sash

ISOLATOR Gen-5 Floor Mounted Fume Hood - This general purpose fume hood is designed to meet most laboratory Constant Air Volume (CAV) or Variable Air Volume (VAV) requirements and supplied with and automatic compensating upper by-pass. For VAV, use option MOD-0004 for a restricted by-pass position of observation glass. Designed to be used with or without an epoxy floor.

The ISOLATOR Gen-5 floor mounted fume hood is supplied with the following standard features:

**Counter Balance Systems** - Chain and sprocket system delivers the easiest and most reliable sash operation available with an exceptional product life-cycle. ISOLATOR drive system provides economical and reliable operation; tested to over 1 million cycles with no failure.

**Sash Design** - 1/4" thick tempered safety glass is provided with epoxy urethane coated steel frames. Optional laminated safety glass or polycarbonate available for special applications. Hood has framed vertical sashes with a superior exterior sightline.

**Stainless Steel Type 304 Exhaust Collar** - Round collar which allows for direct connection to typical exhaust ducts to reduce duct transition costs, minimize static pressure losses and exhaust noise levels.

**Electrical** - Two UL/CSA approved duplex receptacles provided for 120 volt service, one on each corner post. UL/CSA approved LED light fixture and switch provided. Explosion proof fixtures are available options.

**Plumbing** - Both corner posts are pre-punched to accept a maximum of five plumbing fittings per post. Factory pre-plumbing is available as well as plumbing fixtures from a variety of manufacturers to meet most plumbing needs.

**Access Panels** - Interior overlay style access panels provide convenient access and prevent accidental removal. Exterior side panels are also removable for ease of access to plumbing and electrical service fixtures.

**Standards** - UL 1805 Classified and tested in accordance with ASHRAE 110. Test results available upon request.



Rendering shown with optional features

Catalog Number	Width	Clear Interior Depth	Duct Diameter	31 1/2" Vertical Open Upper Sash @ 100 FPM	18" Vertical Open @ 100 FPM
F-203-48G5	48"	24"	1:10"	858 CFM @ .39" SP	501 CFM @ .13" SP
F-203-48G5D30	48"	30"	1:10"	858 CFM @ .39" SP	501 CFM @ .13" SP
F-203-60G5	60"	24"	1:12"	1128 CFM @ .37" SP	660 CFM @ .13" SP
F-203-60G5D30	60"	30"	1:12"	1128 CFM @ .37" SP	660 CFM @ .13" SP
F-203-72G5	72"	24"	1:12"	1399 CFM @ .57" SP	818 CFM @ .19" SP
F-203-72G5D30	72"	30"	1:12"	1399 CFM @ .57" SP	818 CFM @ .19" SP
F-203-96G5	96"	24"	2:10"	1941 CFM @ .50" SP	1135 CFM @ .17" SP
F-203-96G5D30	96"	30"	2:10"	1941 CFM @ .50" SP	1135 CFM @ .17" SP
F-203-120G5	120"	24"	2:12"	2483 CFM @ .45" SP	1451 CFM @ .15" SP
F-203-120G5D30	120"	30"	2:12"	2483 CFM @ .45" SP	1451 CFM @ .15" SP
F-203-144G5	144"	24"	2:12"	3024 CFM @ .66" SP	1768 CFM @ .23" SP
F-203-144G5D30	144"	30"	2:12"	3024 CFM @ .66" SP	1768 CFM @ .23" SP

# F-203 Gen-5 Floor Mounted Fume Hood

F-203-48G5 - 48" Wide

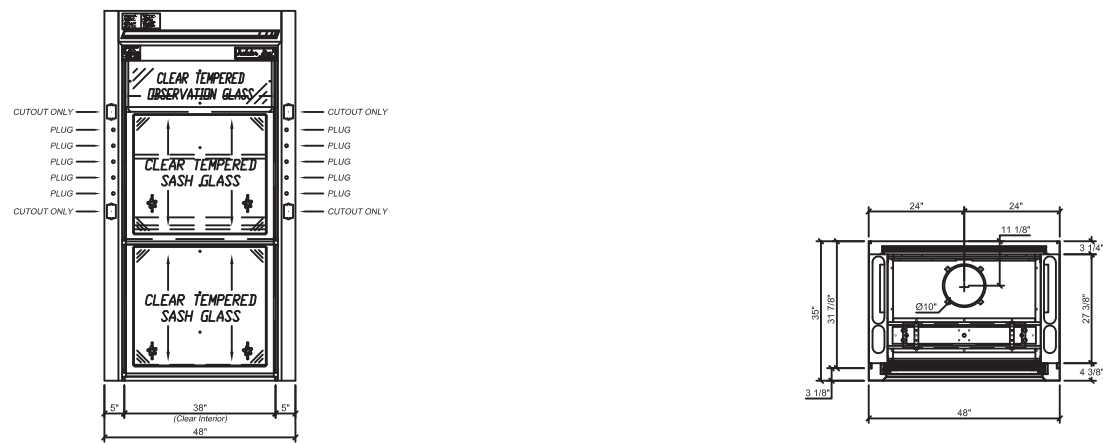

F-203-60G5 - 60" Wide

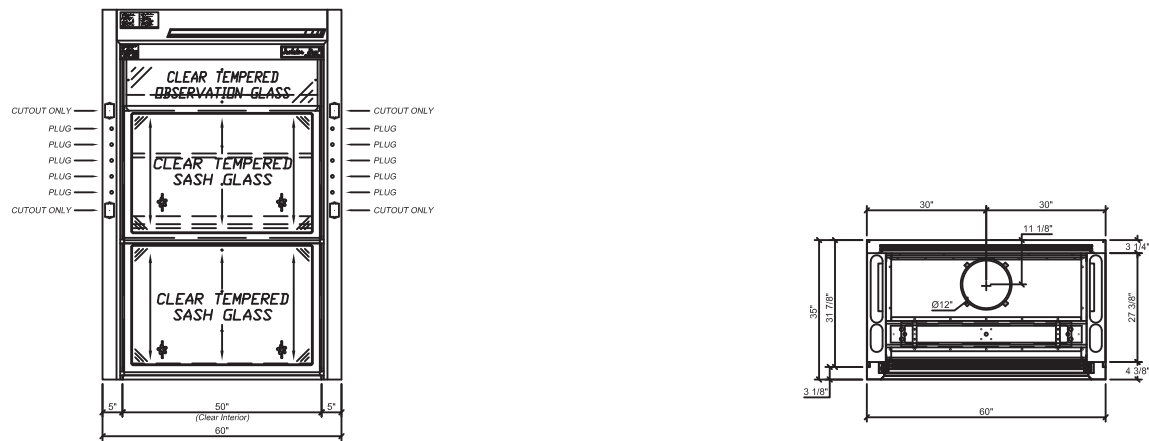

F-203-72G5 - 72" Wide

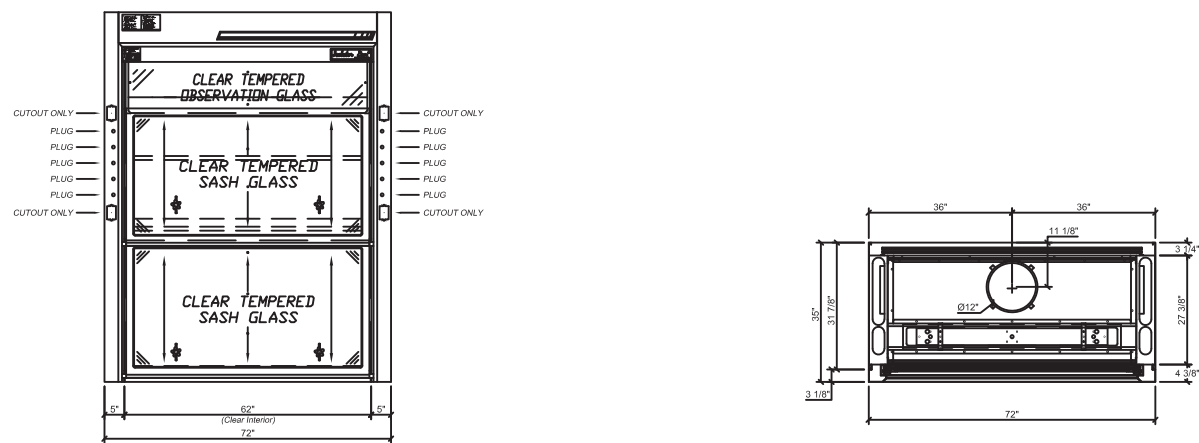

# F-203 Gen-5 Floor Mounted Fume Hood

**F-203-96G5 - 96" Wide**

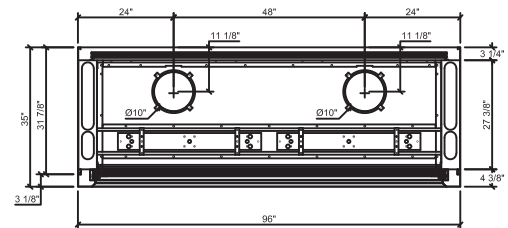
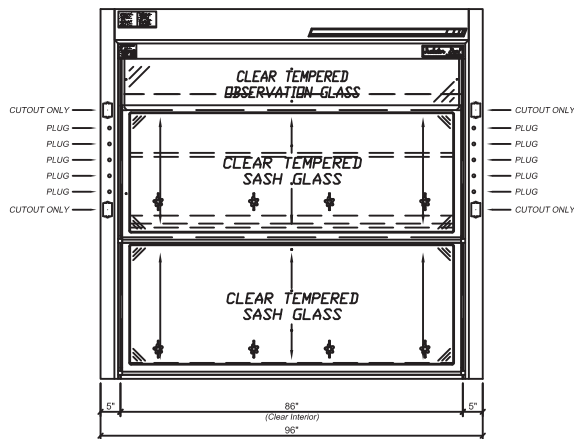

**F-203-120G5 - 120" Wide**

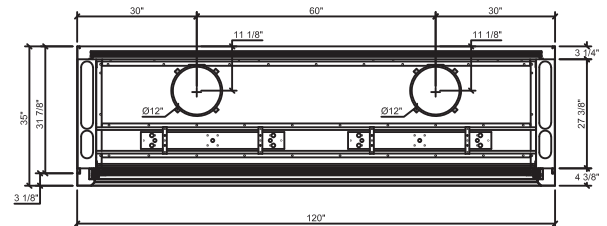
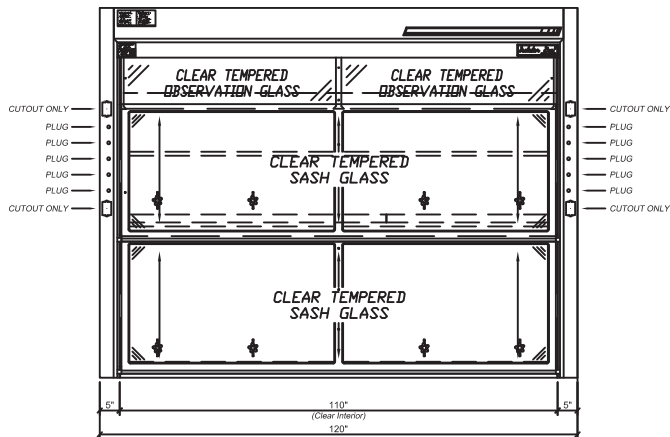

**F-203-144G5 - 144" Wide**

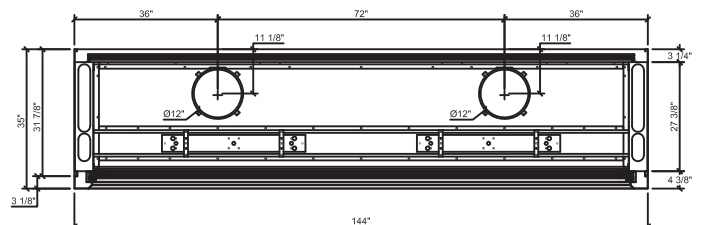
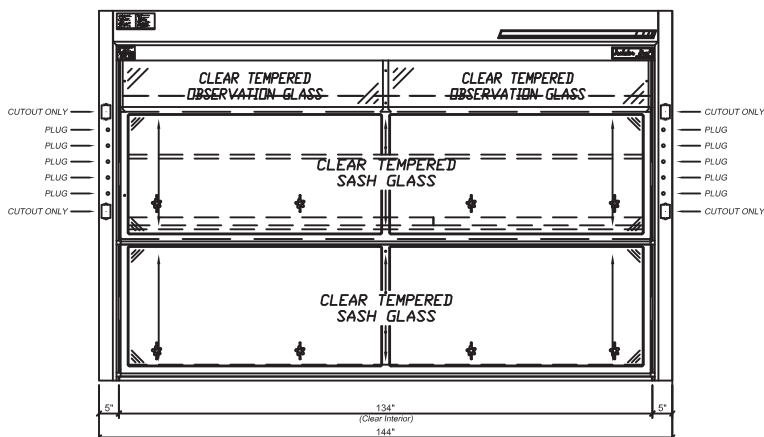



# F-203 Gen-5 Floor Mounted Fume Hood

Section - Standard Depth

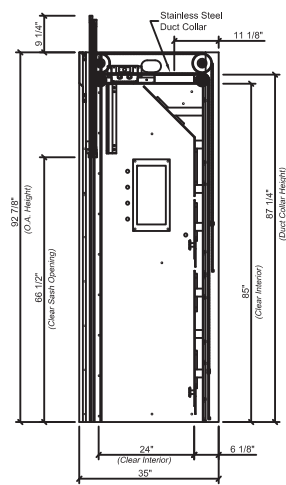

Section - 30" Deep

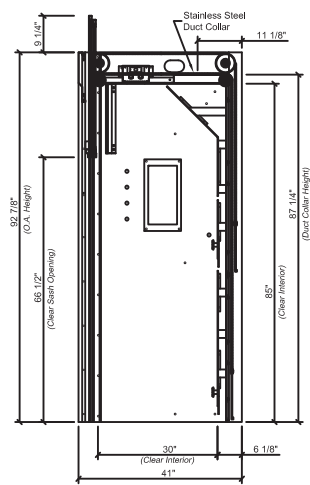

# F-210 Isolator<sup>3</sup> Gen-5 High Performance Floor Mounted Hood

## F-210 Isolator<sup>3</sup> Gen-5 High Performance Fume Hood - Frameless Sash

ISOLATOR<sup>3</sup> Floor Mounted Fume Hood - The high performance fume hood is designed with energy conservation in mind and is ideally suited for environments in which less volume of air is desired. The ICI fume hood has been independently tested and proven to perform at face velocities at between 60 and 63 FPM without auxiliary devices using a Modified ASHRAE test as opposed to the traditional 100FPM. Hoods are cross-draft tested at a constant 58 FPM. This test places the hood under extreme conditions beyond normal. The ISOLATOR<sup>3</sup> floor mounted fume hood is supplied with the following standard features:

**Counter Balance Systems** - Chain and sprocket system delivers the easiest and most reliable sash operation available with an exceptional product life-cycle ISOLATOR drive system provides economical and reliable operation; tested to over 1 million cycles with no failure.

**Sash Design** - 1/4" thick tempered safety glass is provided with an epoxy urethane coated steel handles. Optional laminated safety glass or polycarbonate available for special applications. Hood has a frameless vertical sash with a superior exterior sightline.

**Stainless Steel Type 304 Exhaust Collar** - Round collar which allows for direct connection to typical exhaust ducts to reduce duct transition costs, minimize static pressure losses and exhaust noise levels.

**Electrical** - Two UL/CSA approved duplex receptacles provided for 120 volt service, one on each corner post. UL/CSA approved LED light fixture and switch provided. Explosion proof fixtures are available options.

**Plumbing** - Both corner posts are pre-punched to accept a maximum of five plumbing fittings per post. Factory pre-plumbing is available as well as plumbing fixtures from a variety of manufacturers to meet most plumbing needs.

**Access Panels** - Interior overlay style access panels provide convenient access and prevent accidental removal. Exterior side panels are also removable for ease of access to plumbing and electrical service fixtures.

**Standards** - UL 1805 Classified and tested in accordance with ASHRAE 110. Test results available upon request.

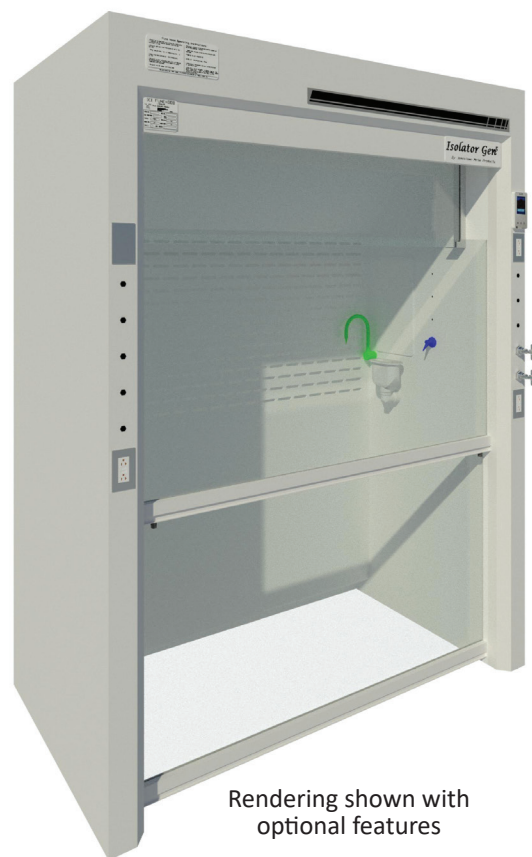

Catalog Number	Width	Clear Interior Depth	Duct Diameter	24" Vertical Open @ 60 FPM	18" Vertical Open @ 80 FPM
F-210-48G5	48"	24"	1:12"	380 CFM @ .12" SP	380 CFM @ .12" SP
F-210-60G5	60"	24"	1:12"	500 CFM @ .11" SP	500 CFM @ .11" SP
F-210-72G5	72"	24"	1:12"	620 CFM @ .17" SP	620 CFM @ .17" SP
F-210-96G5	96"	24"	2:12"	860 CFM @ .15" SP	860 CFM @ .15" SP

# F-210 Isolator<sup>3</sup> Gen-5 High Performance Floor Mounted Hood

**F-210-48G5 - 48" Wide**

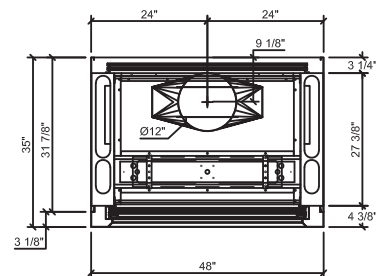
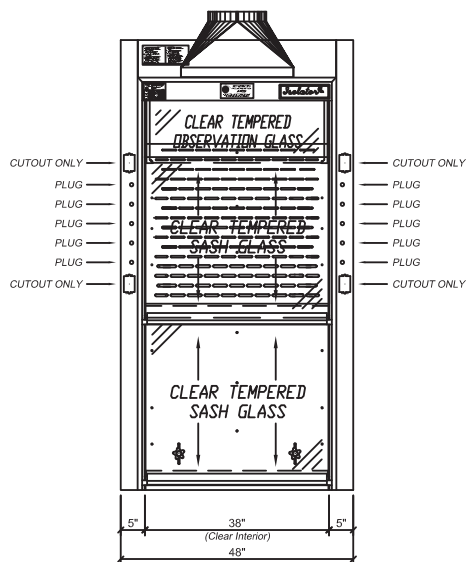

**F-210-60G5 - 60" Wide**

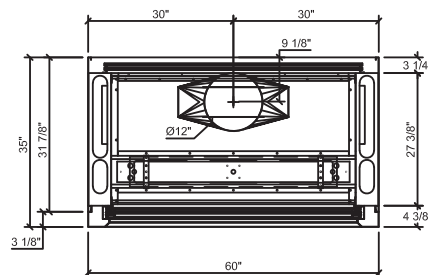
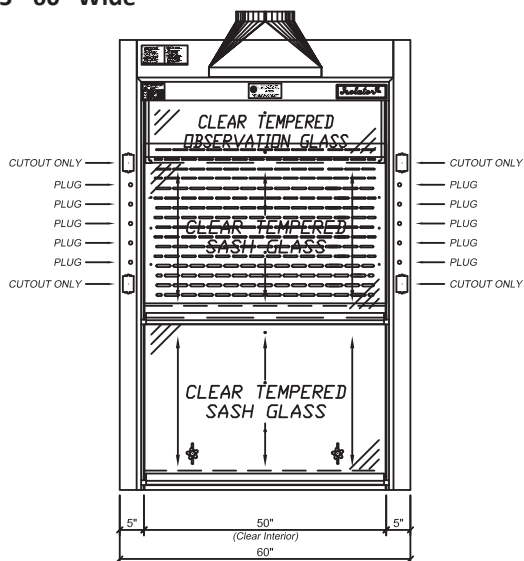

**F-210-72G5 - 72" Wide**

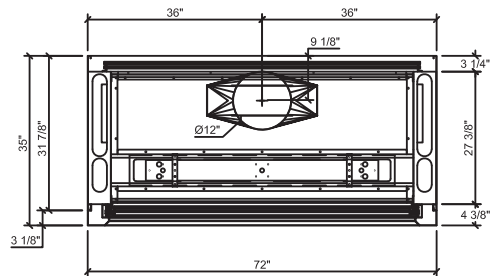
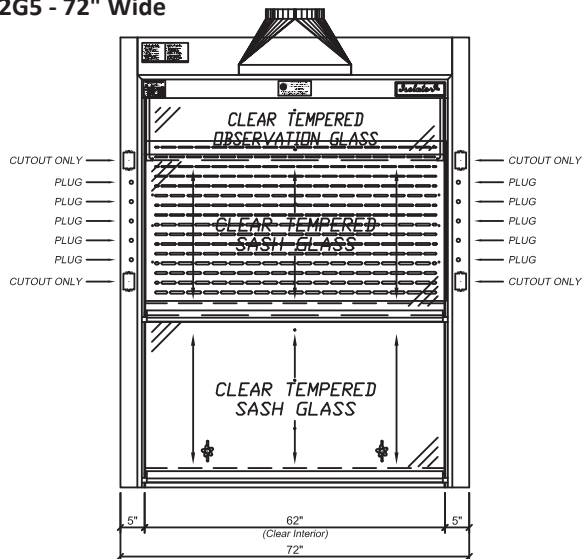

# F-210 Isolator<sup>3</sup> Gen-5 High Performance Floor Mounted Hood

## F-210-96G5 - 96" Wide

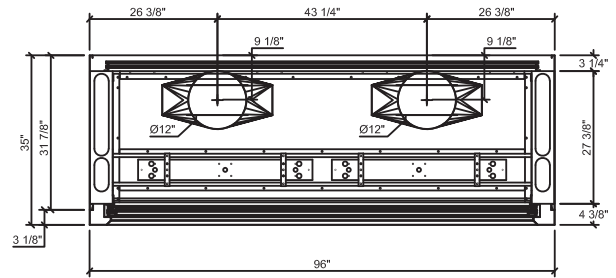
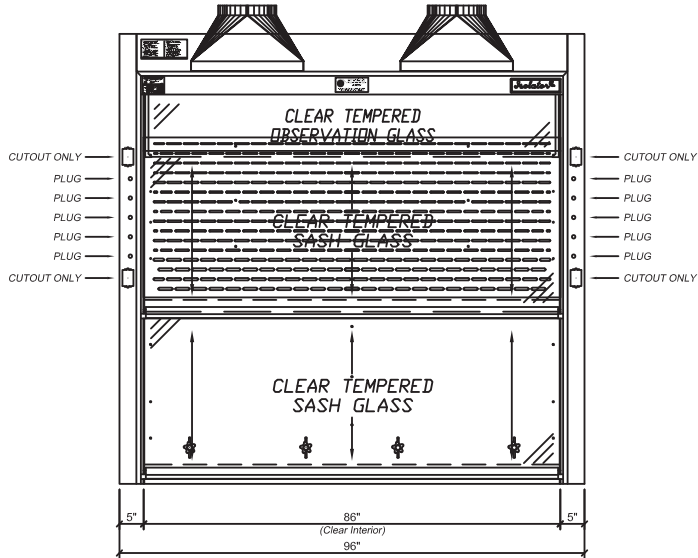

## Section - Standard Depth

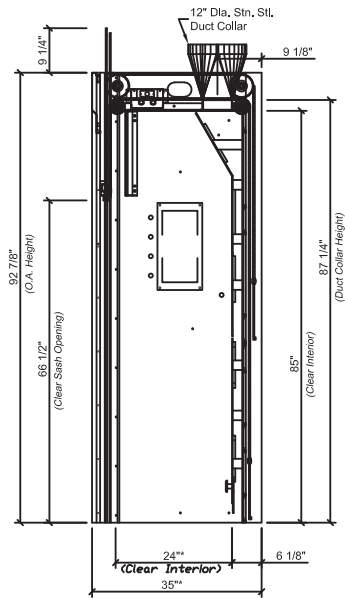

# F-211 Isolator<sup>3</sup> Gen-5 High Performance Floor Mounted Hood

## F-211 Isolator<sup>3</sup> Gen-5 High Performance Fume Hood - Combination Sash

ISOLATOR<sup>3</sup> Floor Mounted Fume Hood - The high performance fume hood is designed with energy conservation in mind and is ideally suited for environments in which less volume of air is desired. The ICI fume hood has been independently tested and proven to perform at face velocities at between 60 and 63 FPM without auxiliary devices using a Modified ASHRAE test as opposed to the traditional 100FPM. Hoods are cross-draft tested at a constant 58 FPM. This test places the hood under extreme conditions beyond normal. The ISOLATOR<sup>3</sup> floor mounted fume hood is supplied with the following standard features:

**Counter Balance Systems** - Chain and sprocket system delivers the easiest and most reliable sash operation available with an exceptional product life-cycle ISOLATOR drive system provides economical and reliable operation; tested to over 1 million cycles with no failure.

**Sash Design** - 1/4" thick tempered safety glass is provided with an stainless steel frame. Optional laminated safety glass or polycarbonate available for special applications. Hood has one combination and one framed vertical sash with a superior exterior sightline.

**Stainless Steel Type 304 Exhaust Collar** - Round collar which allows for direct connection to typical exhaust ducts to reduce duct transition costs, minimize static pressure losses and exhaust noise levels.

**Electrical** - Two UL/CSA approved duplex receptacles provided for 120 volt service, one on each corner post. UL/CSA approved LED light fixture and switch provided. Explosion proof fixtures are available options.

**Plumbing** - Both corner posts are pre-punched to accept a maximum of five plumbing fittings per post. Factory pre-plumbing is available as well as plumbing fixtures from a variety of manufacturers to meet most plumbing needs.

**Access Panels** - Interior overlay style access panels provide convenient access and prevent accidental removal. Exterior side panels are also removable for ease of access to plumbing and electrical service fixtures.

**Standards** - UL 1805 Classified and tested in accordance with ASHRAE 110. Test results available upon request.



Rendering shown with optional features

Catalog Number	Width	Clear Interior Depth	Duct Diameter	24" Vertical Open @ 60 FPM	18" Vertical Open @ 80 FPM
F-211-48G5	48"	24"	1:12"	380 CFM @ .12" SP	380 CFM @ .12" SP
F-211-60G5	60"	24"	1:12"	500 CFM @ .11" SP	500 CFM @ .11" SP
F-211-72G5	72"	24"	1:12"	620 CFM @ .17" SP	620 CFM @ .17" SP
F-211-96G5	96"	24"	2:12"	860 CFM @ .15" SP	860 CFM @ .15" SP

# F-211 Isolator<sup>3</sup> Gen-5 High Performance Floor Mounted Hood

**F-211-48G5 - 48" Wide**

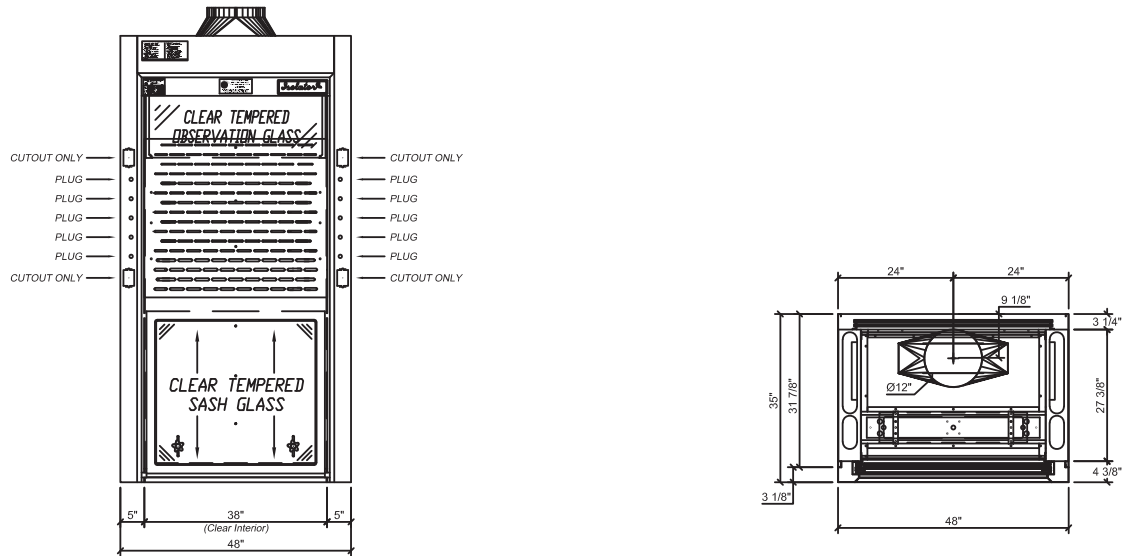

**F-211-60G5 - 60" Wide**

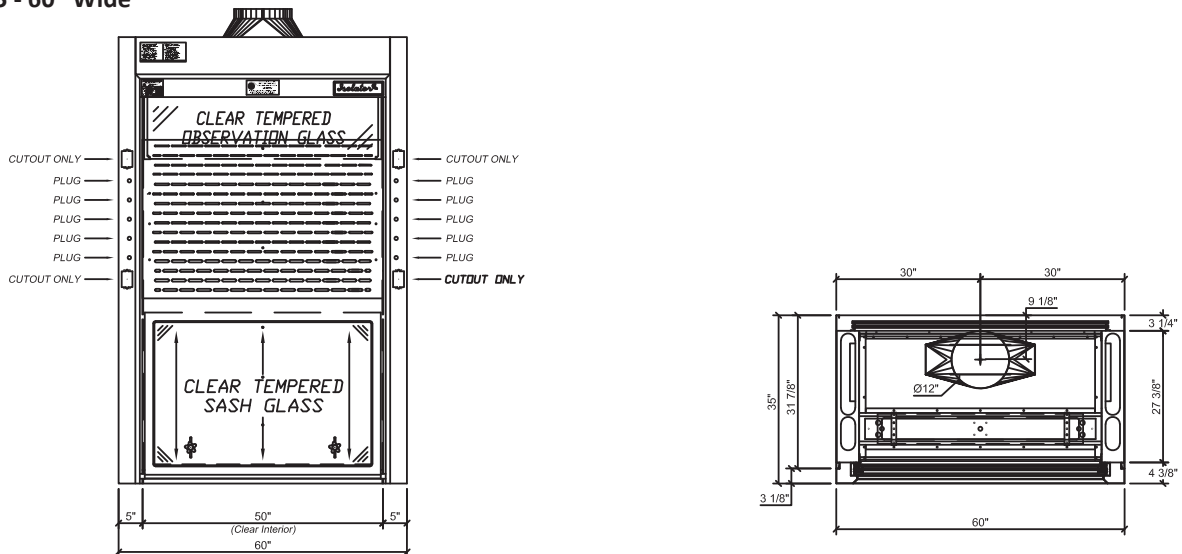

**F-211-72G5 - 72" Wide**

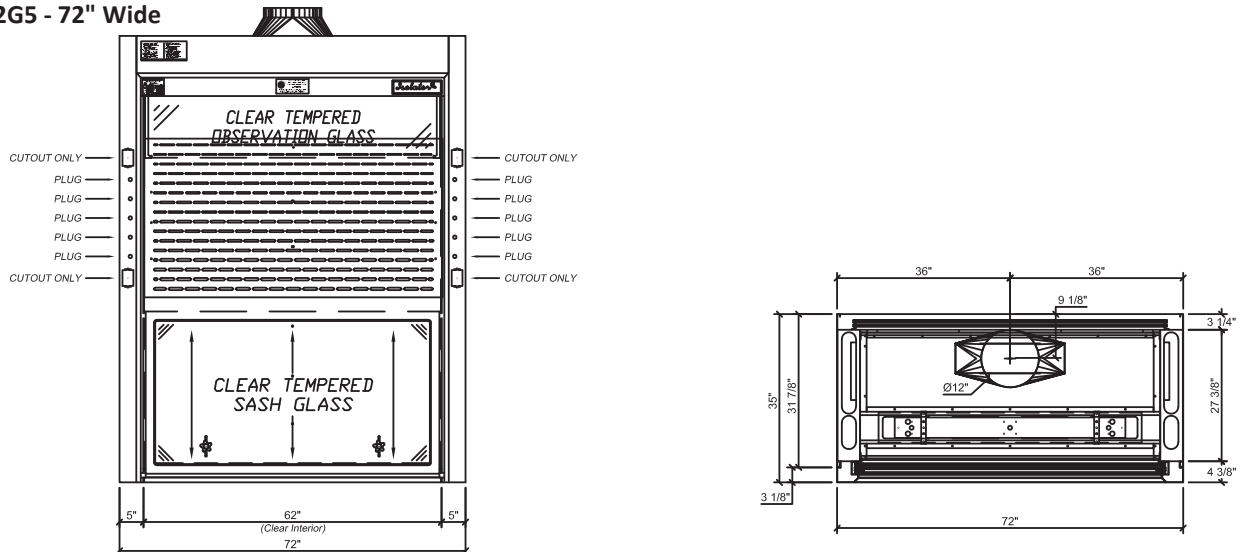

# F-211 Isolator<sup>3</sup> Gen-5 High Performance Floor Mounted Hood

F-211-84G5 - 84" Wide

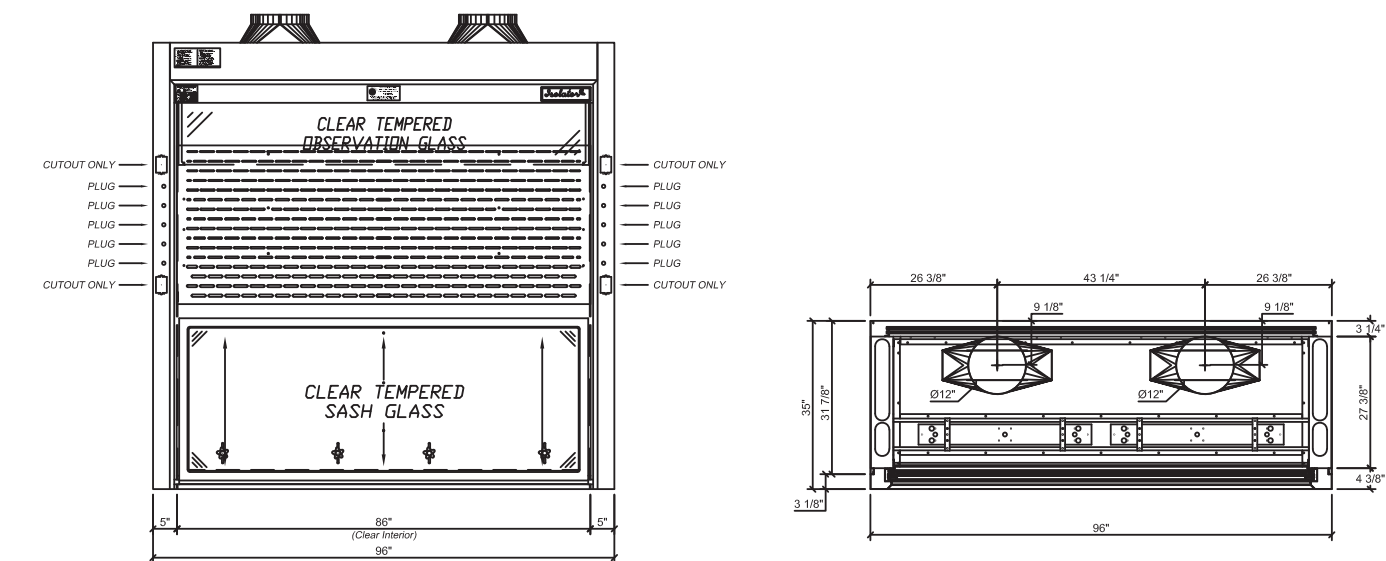

Section - Standard Depth

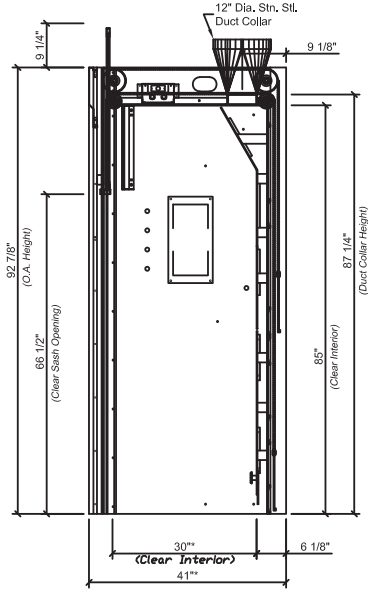



# F-213 Isolator<sup>3</sup> Gen-5 High Performance Floor Mounted Hood

## F-213 Isolator<sup>3</sup> Gen-5 High Performance Fume Hood - Framed Sash

ISOLATOR<sup>3</sup> Floor Mounted Fume Hood - The high performance fume hood is designed with energy conservation in mind and is ideally suited for environments in which less volume of air is desired. The ICI fume hood has been independently tested and proven to perform at face velocities at between 60 and 63 FPM without auxiliary devices using a Modified ASHRAE test as opposed to the traditional 100FPM. Hoods are cross-draft tested at a constant 58 FPM. This test places the hood under extreme conditions beyond normal. The ISOLATOR<sup>3</sup> floor mounted fume hood is supplied with the following standard features:

**Counter Balance Systems** - Chain and sprocket system delivers the easiest and most reliable sash operation available with an exceptional product life-cycle. ISOLATOR drive system provides economical and reliable operation; tested to over 1 million cycles with no failure.

**Sash Design** - 1/4" thick tempered safety glass is provided with epoxy urethane coated steel frames. Optional laminated safety glass or polycarbonate available for special applications. Hood has framed vertical sashes with a superior exterior sightline.

**Stainless Steel Type 304 Exhaust Collar** - Round collar which allows for direct connection to typical exhaust ducts to reduce duct transition costs, minimize static pressure losses and exhaust noise levels.

**Electrical** - Two UL/CSA approved duplex receptacles provided for 120 volt service, one on each corner post. UL/CSA approved LED light fixture and switch provided. Explosion proof fixtures are available options.

**Plumbing** - Both corner posts are pre-punched to accept a maximum of five plumbing fittings per post. Factory pre-plumbing is available as well as plumbing fixtures from a variety of manufacturers to meet most plumbing needs.

**Access Panels** - Interior overlay style access panels provide convenient access and prevent accidental removal. Exterior side panels are also removable for ease of access to plumbing and electrical service fixtures.

**Standards** - UL 1805 Classified and tested in accordance with ASHRAE 110. Test results available upon request.



Catalog Number	Width	Clear Interior Depth	Duct Diameter	24" Vertical Open @ 60 FPM	18" Vertical Open @ 80 FPM
F-213-48G5	48"	24"	1:12"	380 CFM @ .12" SP	380 CFM @ .12" SP
F-213-60G5	60"	24"	1:12"	500 CFM @ .11" SP	500 CFM @ .11" SP
F-213-72G5	72"	24"	1:12"	620 CFM @ .17" SP	620 CFM @ .17" SP
F-213-96G5	96"	24"	2:12"	860 CFM @ .15" SP	860 CFM @ .15" SP

# F-213 Isolator<sup>3</sup> Gen-5 High Performance Floor Mounted Hood

F-213-48G5 - 48" Wide

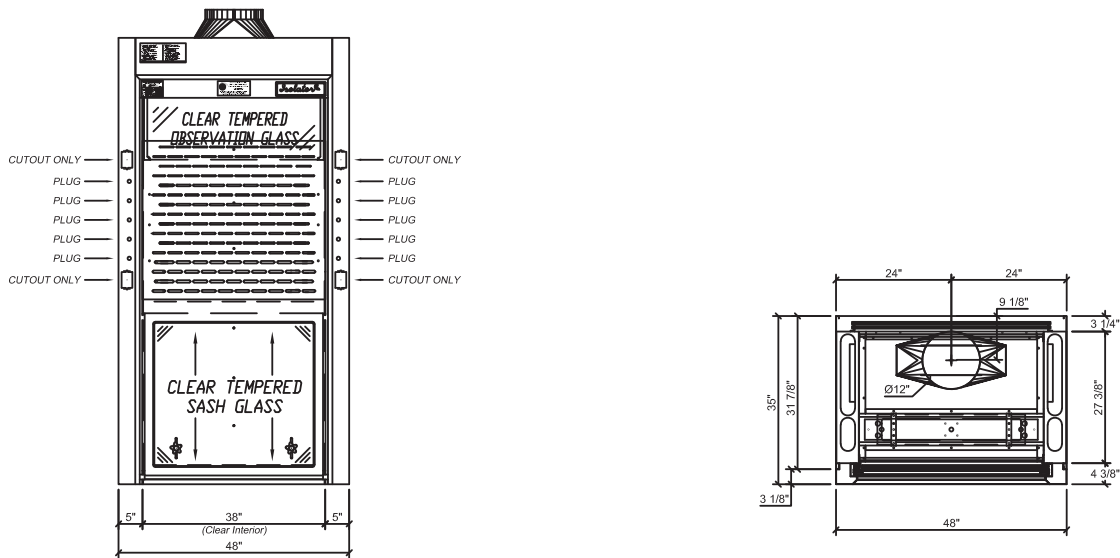

F-213-60G5 - 60" Wide

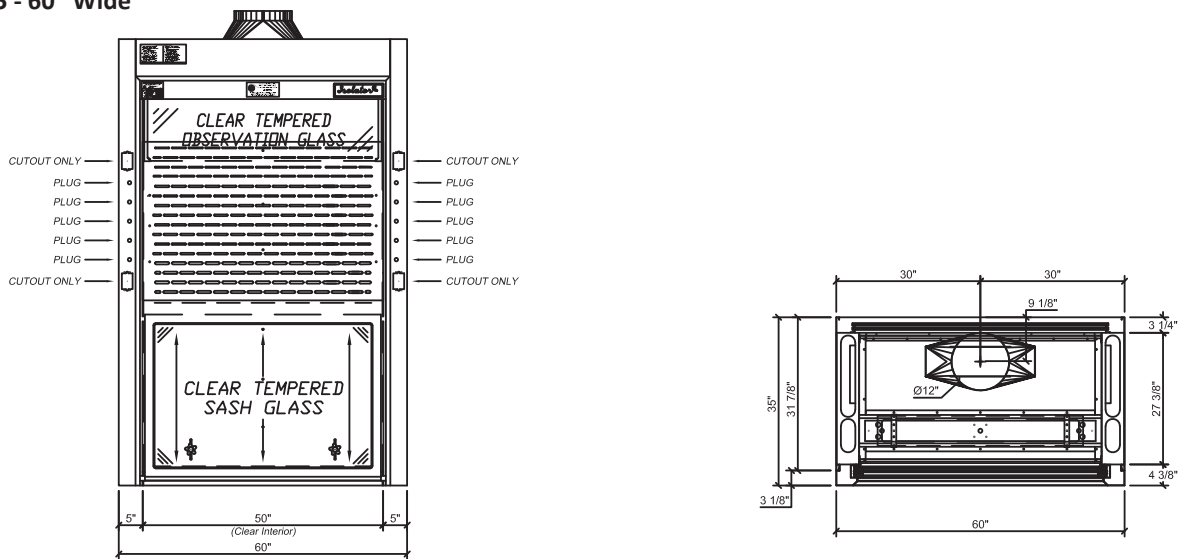

F-213-72G5 - 72" Wide

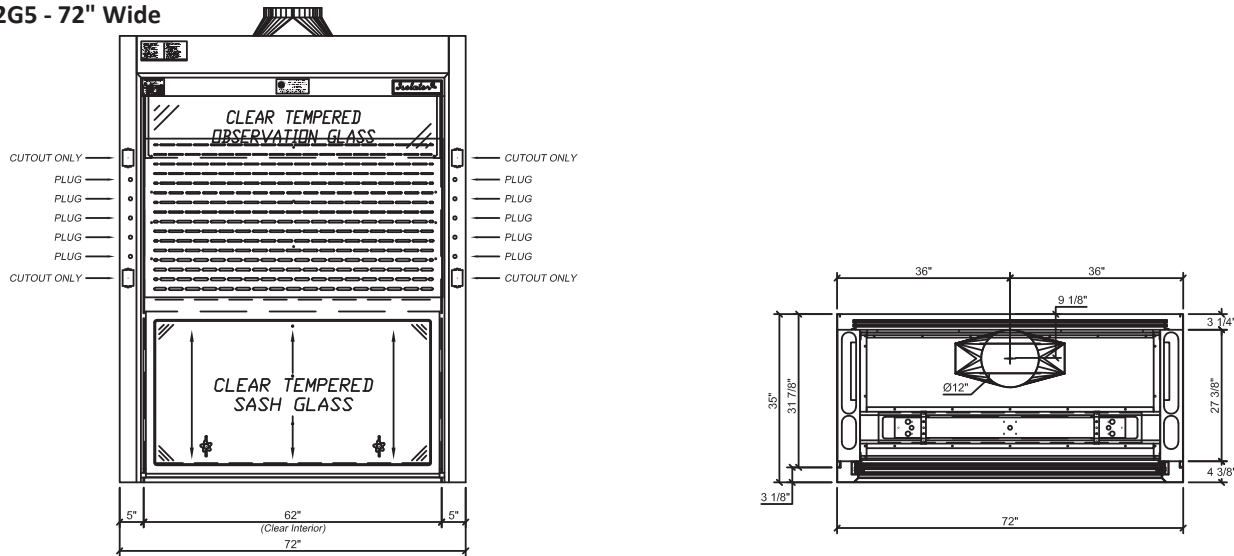

# F-213 Isolator<sup>3</sup> Gen-5 High Performance Floor Mounted Hood

## F-213-96G5 - 96" Wide

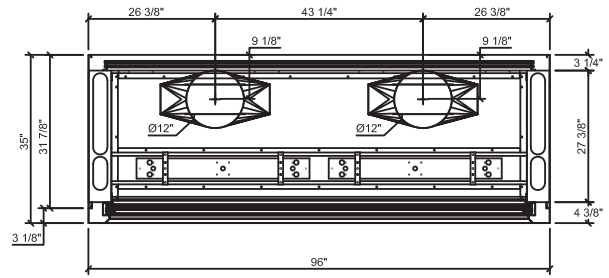
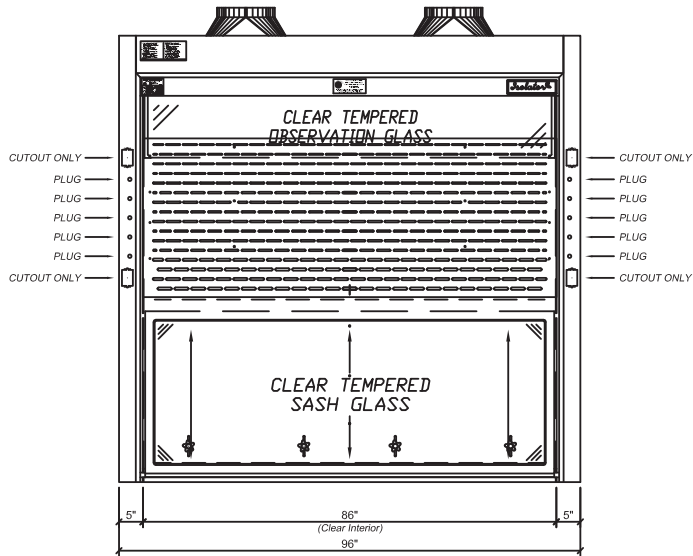

## Section - Standard Depth

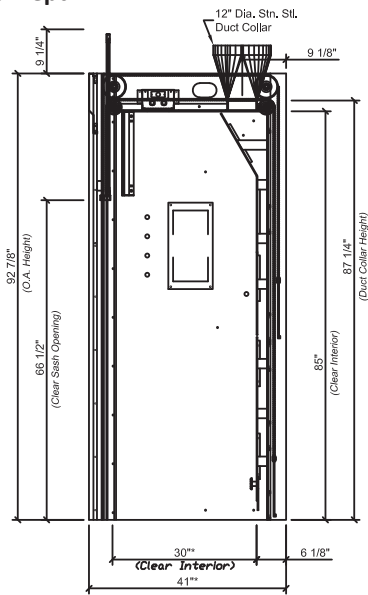

# F-250 Gen-5 Floor Mounted Fume Hood

## F-250 Isolator Gen-5 Floor Mounted Fume Hood - Double Depth - Frameless Vertical Sash

ISOLATOR Gen-5 Floor Mounted Fume Hood - This special purpose fume hood is designed to meet most laboratory Constant Air Volume (CAV) or Variable Air Volume (VAV) requirements and supplied with and automatic compensating upper by-pass. For VAV, use option MOD-0004 for a restricted by-pass position of observation glass. Designed to be used with or without an epoxy floor. The ISOLATOR Gen-5 double depth floor mounted fume hood is supplied with the following standard features:

**Counter Balance Systems** - Chain and sprocket system delivers the easiest and most reliable sash operation available with an exceptional product life-cycle. ISOLATOR drive system provides economical and reliable operation; tested to over 1 million cycles with no failure.

**Sash Design** - 1/4" thick tempered safety glass is provided with an epoxy urethane coated steel frame. Optional laminated safety glass or polycarbonate available for special applications. Hood has one combination and one framed vertical sash with a superior exterior sightline.

**Stainless Steel Type 304 Exhaust Collar** - Round collar which allows for direct connection to typical exhaust ducts to reduce duct transition costs, minimize static pressure losses and exhaust noise levels.

**Electrical** - Two UL/CSA approved duplex receptacles provided for 120 volt service, one on each corner post. UL/CSA approved LED light fixture and switch provided. Explosion proof fixtures are available options.

**Plumbing** - Both corner posts are pre-punched to accept a maximum of five plumbing fittings per post. Factory pre-plumbing is available as well as plumbing fixtures from a variety of manufacturers to meet most plumbing needs.

**Access Panels** - Interior overlay style access panels provide convenient access and prevent accidental removal. Exterior side panels are also removable for ease of access to plumbing and electrical service fixtures.

**Standards** - UL 1805 Classified and tested in accordance with ASHRAE 110. Test results available upon request.



Rendering shown with optional features

Catalog Number	Width	Clear Interior Depth	Duct Diameter	31 1/2" Vertical Open Upper Sash @ 100 FPM	18" Vertical Open @ 100 FPM
F-250-72G5	72"	48"	1:12"	1399 CFM @ .57" SP	818 CFM @ .19" SP
F-250-96G5	96"	48"	2:10"	1941 CFM @ .50" SP	1135 CFM @ .17" SP

# F-250 Gen-5 Floor Mounted Fume Hood

## F-250-72G5 - 72" Wide

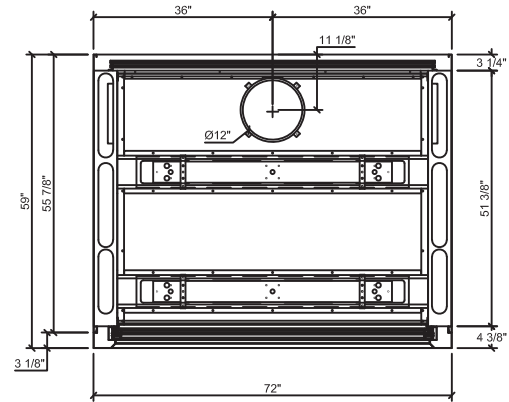
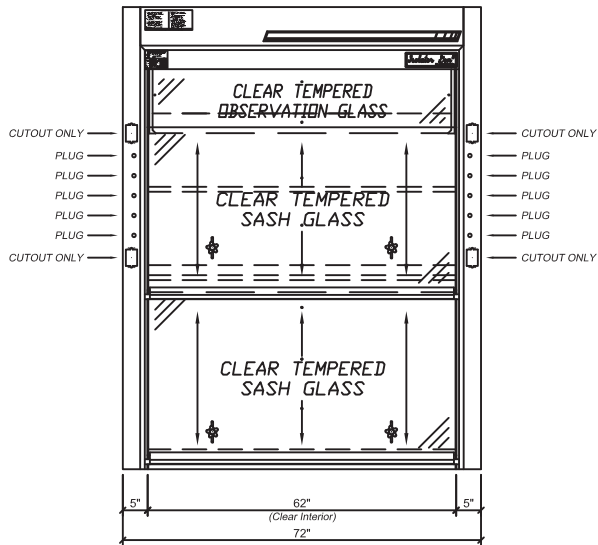

## F-250-96G5 - 96" Wide

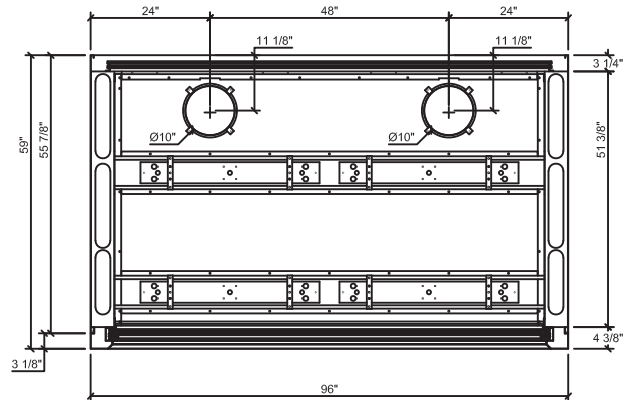
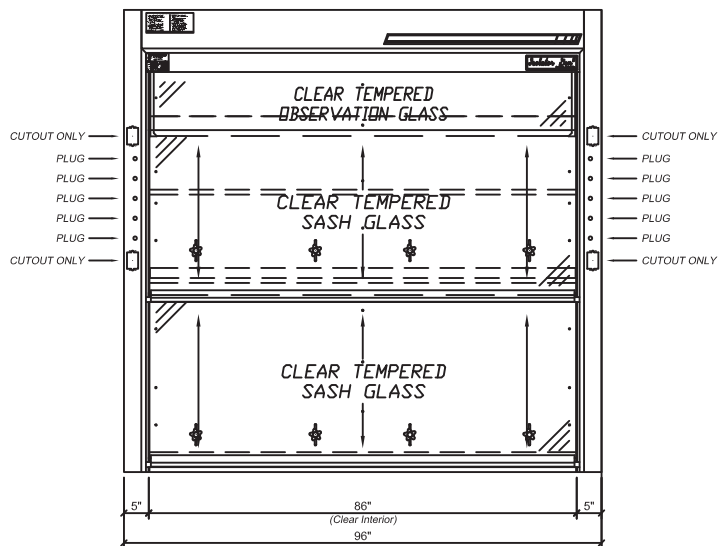

## Section - Double Depth

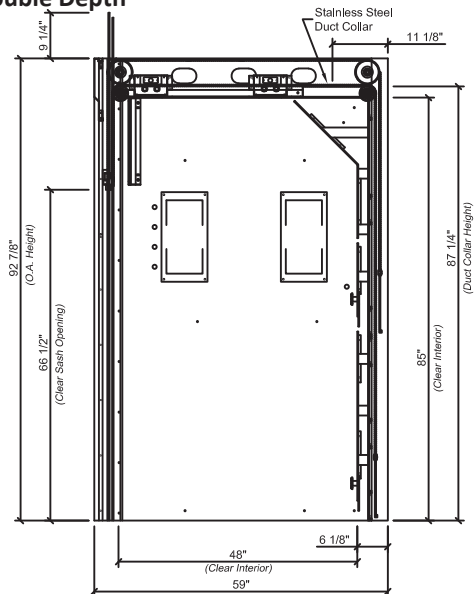

# F-251 Gen-5 Floor Mounted Fume Hood

## F-251 Isolator Gen-5 Floor Mounted Fume Hood - Double Depth - Combination Sash

ISOLATOR Gen-5 Floor Mounted Fume Hood - This special purpose fume hood is designed to meet most laboratory Constant Air Volume (CAV) or Variable Air Volume (VAV) requirements and supplied with and automatic compensating upper by-pass. For VAV, use option MOD-0004 for a restricted by-pass position of observation glass. Designed to be used with or without an epoxy floor. The ISOLATOR Gen-5 double depth floor mounted fume hood is supplied with the following standard features:

**Counter Balance Systems** - Chain and sprocket system delivers the easiest and most reliable sash operation available with an exceptional product life-cycle. ISOLATOR drive system provides economical and reliable operation; tested to over 1 million cycles with no failure.

**Sash Design** - 1/4" thick tempered safety glass is provided with a stainless steel frame. Optional laminated safety glass or polycarbonate available for special applications. Hood has one combination and one framed vertical sash with a superior exterior sightline.

**Stainless Steel Type 304 Exhaust Collar** - Round collar which allows for direct connection to typical exhaust ducts to reduce duct transition costs, minimize static pressure losses and exhaust noise levels.

**Electrical** - Two UL/CSA approved duplex receptacles provided for 120 volt service, one on each corner post. UL/CSA approved LED light fixture and switch provided. Explosion proof fixtures are available options.

**Plumbing** - Both corner posts are pre-punched to accept a maximum of five plumbing fittings per post. Factory pre-plumbing is available as well as plumbing fixtures from a variety of manufacturers to meet most plumbing needs.

**Access Panels** - Interior overlay style access panels provide convenient access and prevent accidental removal. Exterior side panels are also removable for ease of access to plumbing and electrical service fixtures.

**Standards** - UL 1805 Classified and tested in accordance with ASHRAE 110. Test results available upon request.



Rendering shown with optional features

Catalog Number	Width	Clear Interior Depth	Duct Diameter	31 1/2" Vertical Open Upper Sash @ 100 FPM	18" Vertical Open @ 100 FPM	50% Horizontal Open @ 100 FPM
F-251-72G5	72"	48"	1:12"	1399 CFM @ .57" SP	818 CFM @ .19" SP	739 CFM @ .16" SP
F-251-96G5	96"	48"	2:10"	1941 CFM @ .50" SP	1135 CFM @ .17" SP	1035 CFM @ .14" SP
F-251-120G5	120"	48"	2:12"	2483 CFM @ .45" SP	1451 CFM @ .15" SP	1330 CFM @ .13" SP
F-251-144G5	144"	48"	2:12"	3024 CFM @ .66" SP	1768 CFM @ .23" SP	1628 CFM @ .19" SP

50% open may be achieved two ways: 1. vertical sash open 14", horizontal panels closed or 2. vertical sash closed, horizontal panels full open

# F-251 Gen-5 Floor Mounted Fume Hood

## F-251-72G5 - 72" Wide

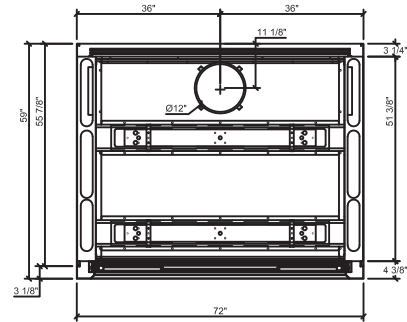
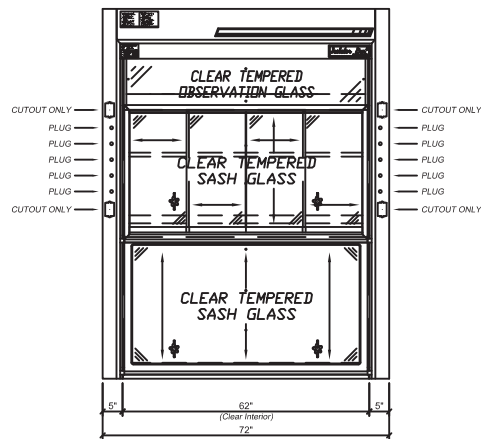

## F-251-96G5 - 96" Wide

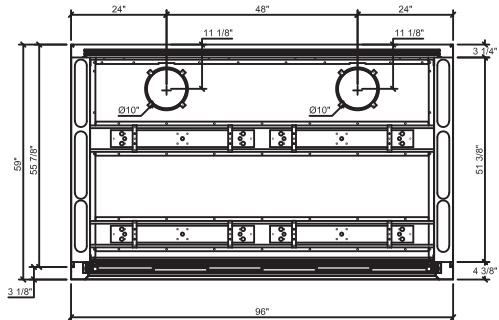
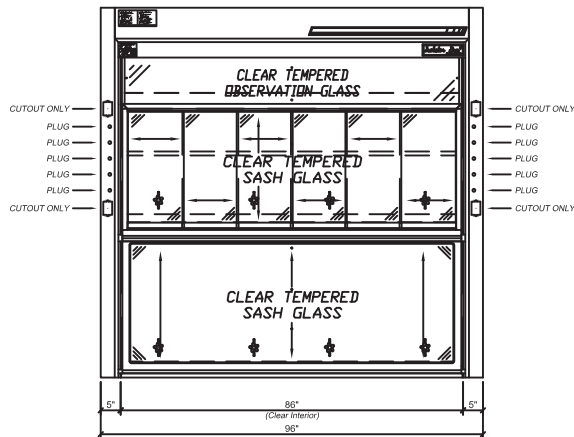

## F-251-120G5 - 120" Wide

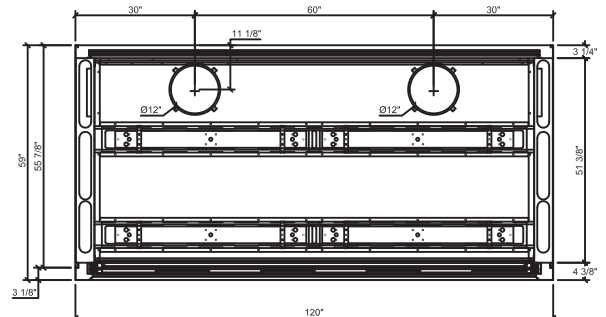
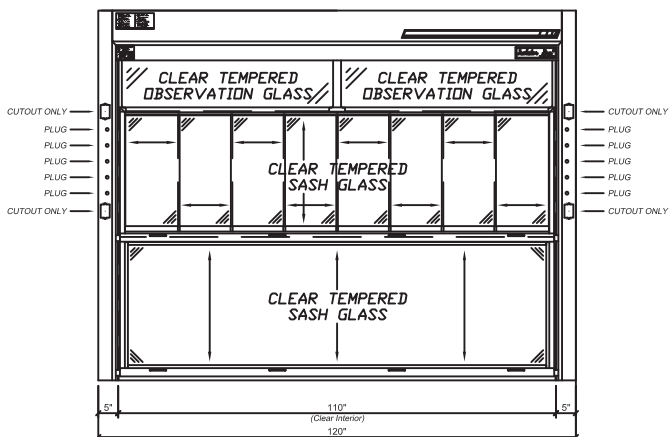



# F-251 Gen-5 Floor Mounted Fume Hood

F-251-144G5 - 144" Wide

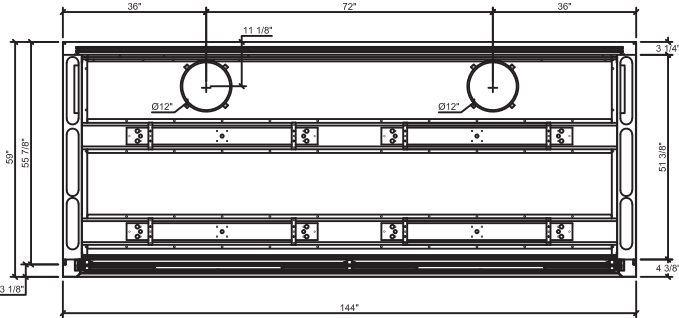
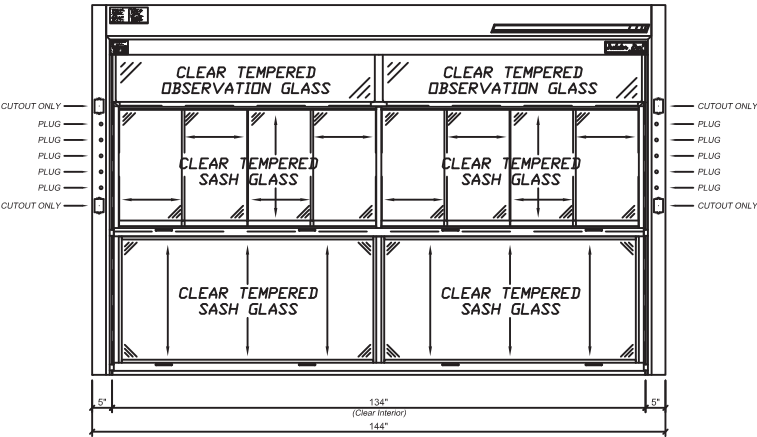

## Section - Double Depth

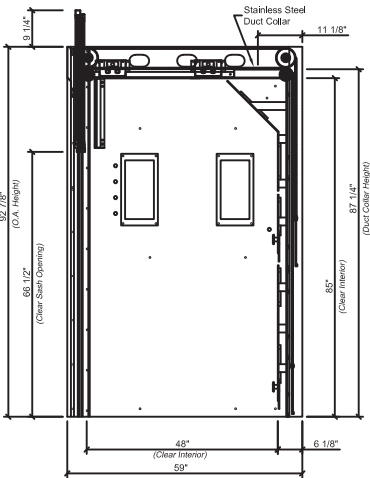

# F-252 Gen-5 Floor Mounted Fume Hood

## F-252 Isolator Gen-5 Floor Mounted Fume Hood - Double Depth - Horizontal Sash

ISOLATOR Gen-5 Floor Mounted Fume Hood - This special purpose fume hood is designed to meet most laboratory Constant Air Volume (CAV) or Variable Air Volume (VAV) requirements and supplied with and automatic compensating upper by-pass. For VAV, use option MOD-0004 for a restricted by-pass position of observation glass. Designed to be used with or without an epoxy floor. The ISOLATOR Gen-5 double depth floor mounted fume hood is supplied with the following standard features:

**Track System** – Top hung roller bearing framed sashes offer an exceptional product life-cycle

**Sash Design** - 1/4" thick tempered safety glass is provided with an epoxy urethane coated steel frame. Optional laminated safety glass or polycarbonate available for special applications. Hood has framed horizontal sashes with a superior exterior sightline.

**Stainless Steel Type 304 Exhaust Collar** - Round collar which allows for direct connection to typical exhaust ducts to reduce duct transition costs, minimize static pressure losses and exhaust noise levels.

**Electrical** - Two UL/CSA approved duplex receptacles provided for 120 volt service, one on each corner post. UL/CSA approved LED light fixture and switch provided. Explosion proof fixtures are available options.

**Plumbing** - Both corner posts are pre-punched to accept a maximum of five plumbing fittings per post. Factory pre-plumbing is available as well as plumbing fixtures from a variety of manufacturers to meet most plumbing needs.

**Access Panels** - Interior overlay style access panels provide convenient access and prevent accidental removal. Exterior side panels are also removable for ease of access to plumbing and electrical service fixtures.

**Standards** - UL 1805 Classified and tested in accordance with ASHRAE 110. Test results available upon request.



Rendering shown with optional features

Catalog Number	Width	Clear Interior Depth	Duct Diameter	28" Open Upper Sash @ 100 FPM	50% Horizontal Open @ 100 FPM
F-252-72G5	72"	48"	1:12"	N/A	1451 CFM @ .61" SP
F-252-96G5	96"	48"	2:10"	N/A	1994 CFM @ .53" SP
F-252-120G5	120"	48"	2:12"	N/A	2600 CFM @ .49" SP
F-252-144G5	144"	48"	2:12"	N/A	3144 CFM @ .72" SP

50% open may be achieved two ways: 1. vertical sash open 14", horizontal panels closed or 2. vertical sash closed, horizontal panels full open

# F-252 Gen-5 Floor Mounted Fume Hood

F-252-72G5 - 72" Wide

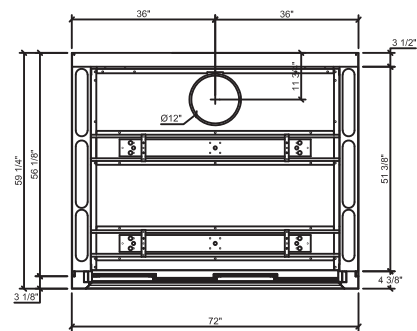
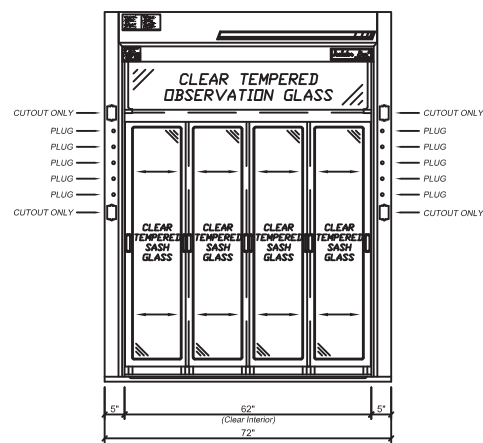

F-252-96G5 - 96" Wide

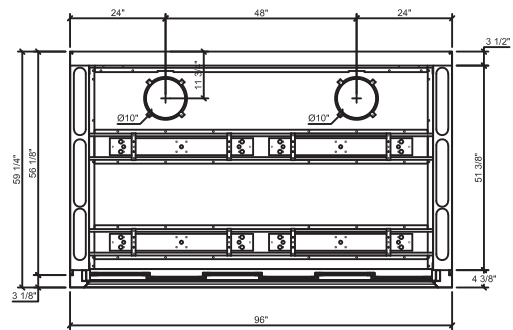
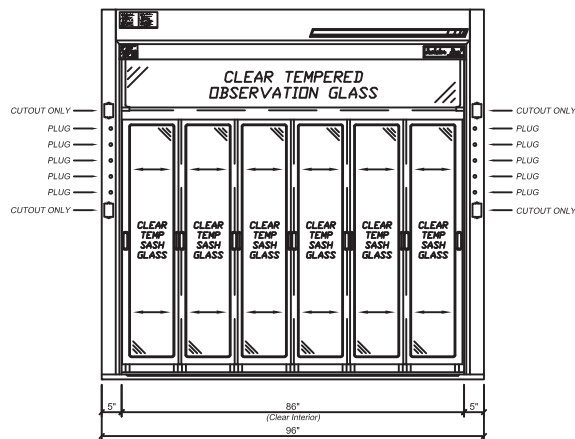

F-252-120G5 - 120" Wide

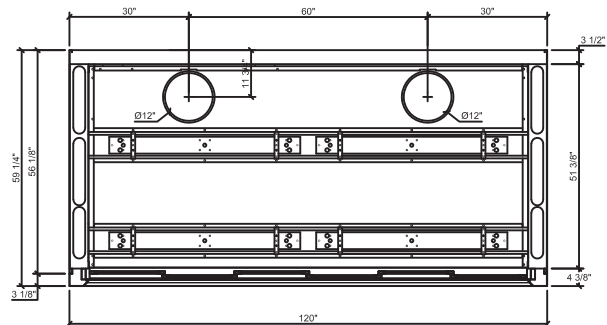
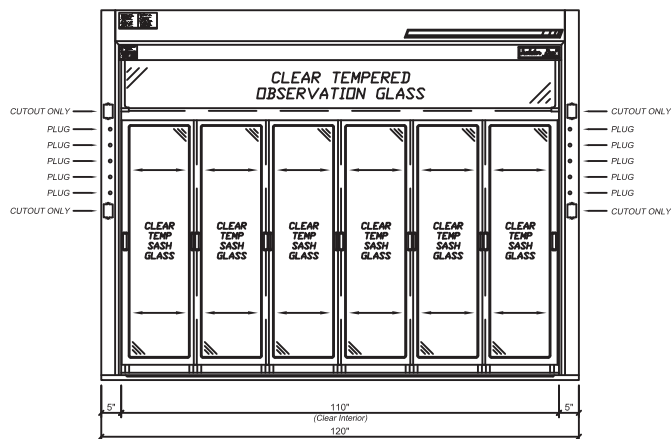

# F-252 Gen-5 Floor Mounted Fume Hood

## F-252-144G5 - 144" Wide

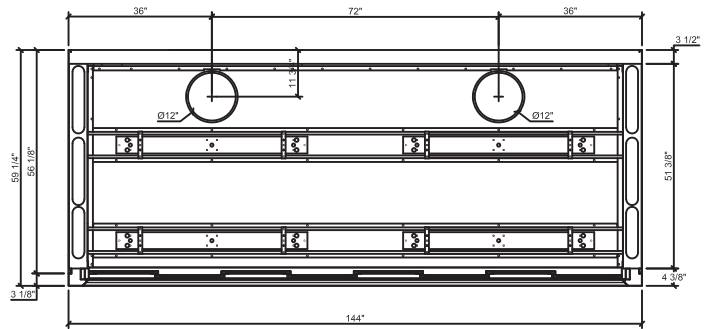
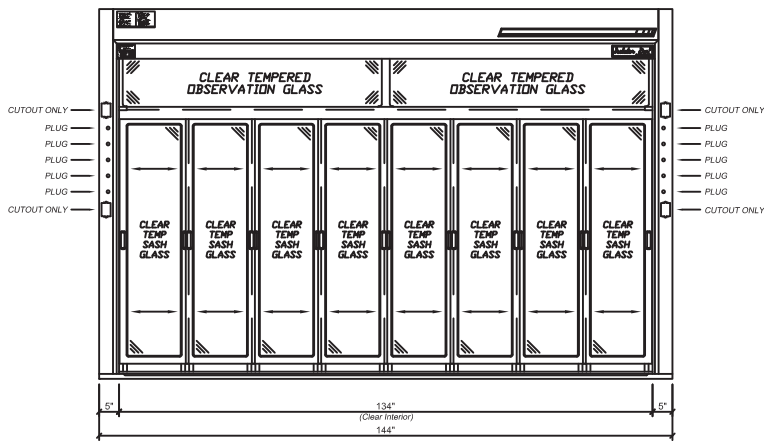

## Section - Double Depth

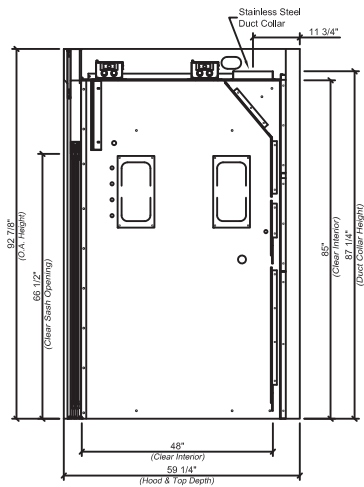

# F-253 Gen-5 Floor Mounted Fume Hood

## F-253 Isolator Gen-5 Floor Mounted Fume Hood - Double Depth - Framed Vertical Sash

ISOLATOR Gen-5 Floor Mounted Fume Hood - This special purpose fume hood is designed to meet most laboratory Constant Air Volume (CAV) or Variable Air Volume (VAV) requirements and supplied with and automatic compensating upper by-pass. For VAV, use option MOD-0004 for a restricted by-pass position of observation glass. Designed to be used with or without an epoxy floor. The ISOLATOR Gen-5 double depth floor mounted fume hood is supplied with the following standard features:

**Counter Balance Systems** - Chain and sprocket system delivers the easiest and most reliable sash operation available with an exceptional product life-cycle. ISOLATOR drive system provides economical and reliable operation; tested to over 1 million cycles with no failure.

**Sash Design** - 1/4" thick tempered safety glass is provided with an epoxy urethane coated steel frame. Optional laminated safety glass or polycarbonate available for special applications. Hood has framed vertical sashes with a superior exterior sightline.

**Stainless Steel Type 304 Exhaust Collar** - Round collar which allows for direct connection to typical exhaust ducts to reduce duct transition costs, minimize static pressure losses and exhaust noise levels.

**Electrical** - Two UL/CSA approved duplex receptacles provided for 120 volt service, one on each corner post. UL/CSA approved LED light fixture and switch provided. Explosion proof fixtures are available options.

**Plumbing** - Both corner posts are pre-punched to accept a maximum of five plumbing fittings per post. Factory pre-plumbing is available as well as plumbing fixtures from a variety of manufacturers to meet most plumbing needs.

**Access Panels** - Interior overlay style access panels provide convenient access and prevent accidental removal. Exterior side panels are also removable for ease of access to plumbing and electrical service fixtures.

**Standards** - UL 1805 Classified and tested in accordance with ASHRAE 110. Test results available upon request.



Rendering shown with optional features

Catalog Number	Width	Clear Interior Depth	Duct Diameter	31 1/2" Vertical Open Upper Sash @ 100 FPM	18" Vertical Open Upper Sash @ 100 FPM
F-253-72G5	72"	48"	1:12"	1399 CFM @ .57" SP	818 CFM @ .19" SP
F-253-96G5	96"	48"	2:10"	1941 CFM @ .50" SP	1135 CFM @ .17" SP
F-253-120G5	120"	48"	2:12"	2483 CFM @ .45" SP	1451 CFM @ .15" SP
F-253-144G5	144"	48"	2:12"	3024 CFM @ .66" SP	1768 CFM @ .23" SP

# F-253 Gen-5 Floor Mounted Fume Hood

**F-253-72G5 - 72" Wide**

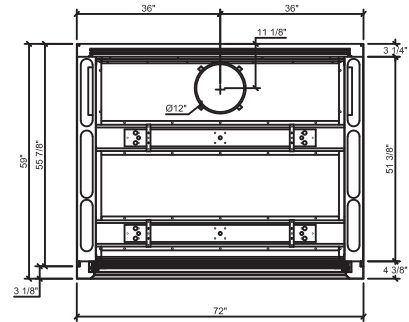
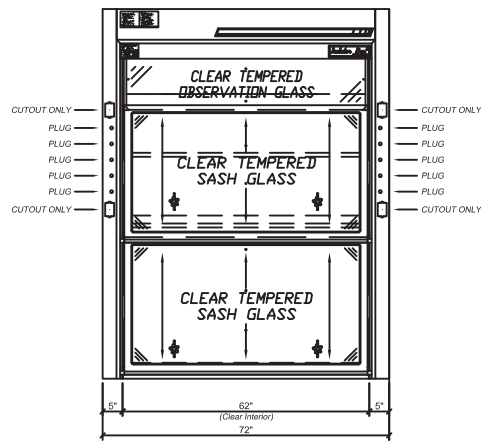

**F-253-96G5 - 96" Wide**

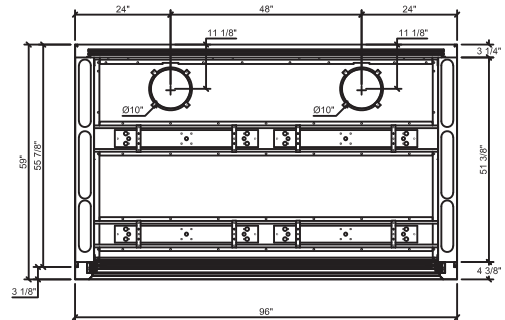
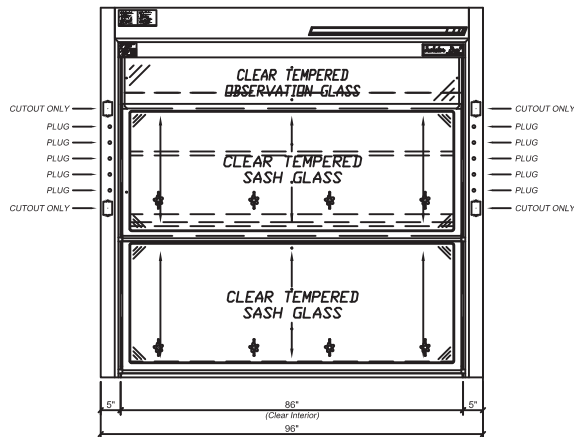

**F-253-120G5 - 120" Wide**

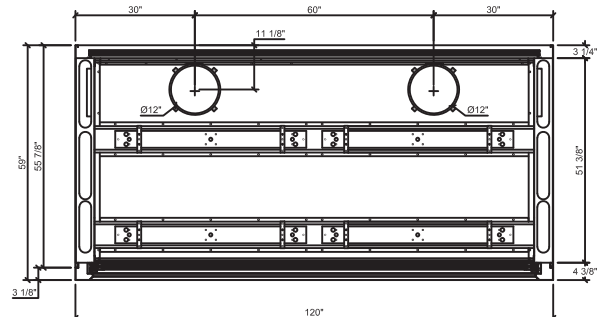
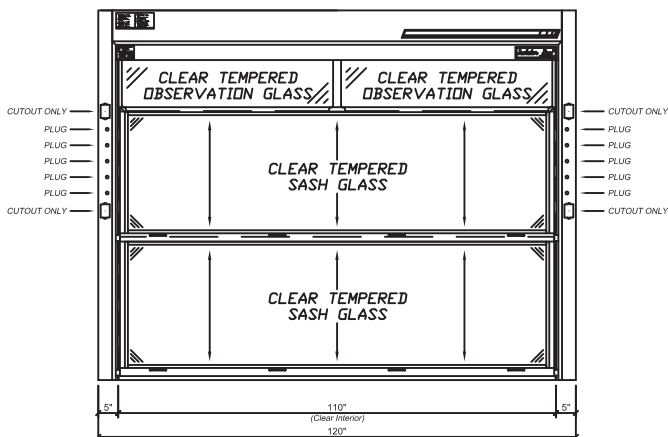

# F-253 Gen-5 Floor Mounted Fume Hood

F-253-144G5 - 144" Wide

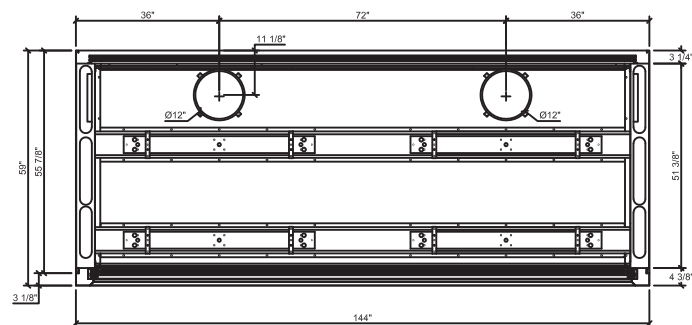
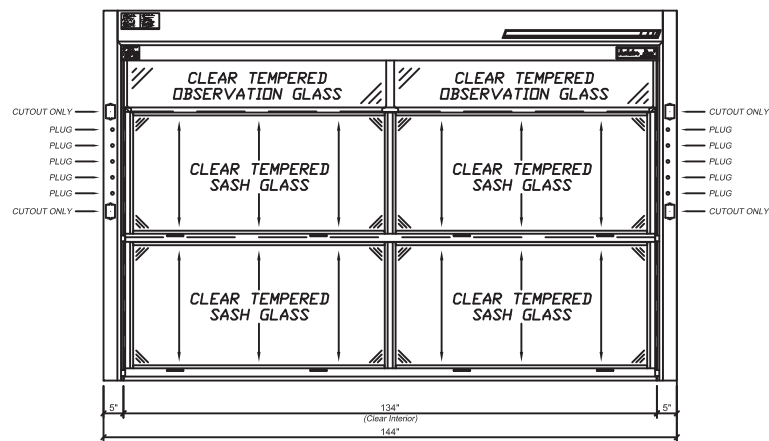

## Section - Double Depth

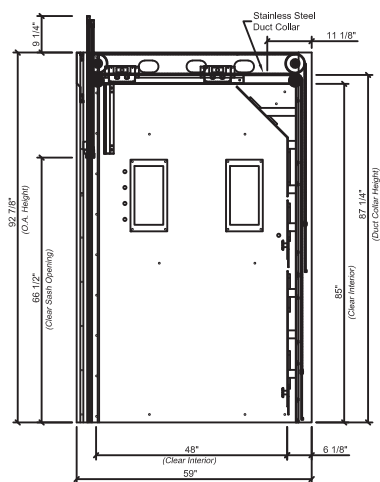



# F-292 Gen-5 Floor Mounted Fume Hood

## F-292 Isolator Gen-5 Floor Mounted Fume Hood - Double Depth/Double Sided - Horizontal Sash

ISOLATOR Gen-5 Floor Mounted Fume Hood - This special purpose fume hood is designed to meet most laboratory Constant Air Volume (CAV) or Variable Air Volume (VAV) requirements and supplied with and automatic compensating upper by-pass. For VAV, use option MOD-0004 for a restricted by-pass position of observation glass. Designed to be used with or without an epoxy floor. The ISOLATOR Gen-5 double sided, double depth floor mounted fume hood is supplied with the following standard features:

**Track System** – Top hung roller bearing framed sashes offer an exceptional product life-cycle

**Sash Design** - 1/4" thick tempered safety glass is provided with an epoxy urethane coated steel frames. Optional laminated safety glass or polycarbonate available for special applications. Hood has framed horizontal sashes with a superior exterior sightline.

**Stainless Steel Type 304 Exhaust Collar** - Round collar which allows for direct connection to typical exhaust ducts to reduce duct transition costs, minimize static pressure losses and exhaust noise levels.

**Electrical** - Two UL/CSA approved duplex receptacles provided for 120 volt service, one on each corner post. UL/CSA approved LED light fixture and switch provided. Explosion proof fixtures are available options.

**Plumbing** - Both corner posts are pre-punched to accept a maximum of five plumbing fittings per post. Factory pre-plumbing is available as well as plumbing fixtures from a variety of manufacturers to meet most plumbing needs.

**Access Panels** - Interior overlay style access panels provide convenient access and prevent accidental removal. Exterior side panels are also removable for ease of access to plumbing and electrical service fixtures.

**Standards** - UL 1805 Classified and tested in accordance with ASHRAE 110. Test results available upon request.



Catalog Number	Width	Clear Interior Depth	Duct Diameter	31 1/2" Vertical Open Upper Sash @ 100 FPM	18" Vertical Open Upper Sash @ 100 FPM
F-292-72G5	72"	48"	1:10"	N/A	1624 CFM @ .76" SP
F-292-96G5	96"	48"	2:10"	N/A	2235 CFM @ .66" SP
F-292-120G5	120"	48"	2:12"	N/A	2907 CFM @ .61" SP
F-292-144G5	144"	48"	2:12"	N/A	3518 CFM @ .90" SP

# F-292 Gen-5 Floor Mounted Fume Hood

F-292-72G5 - 72" Wide

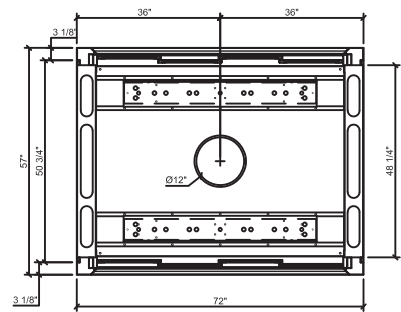
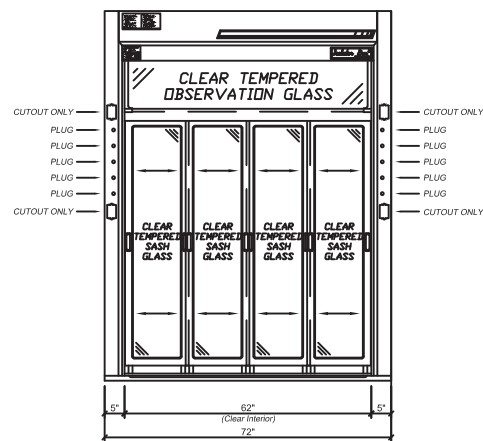

F-292-96G5 - 96" Wide

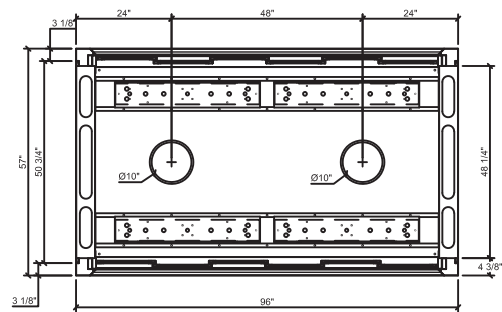
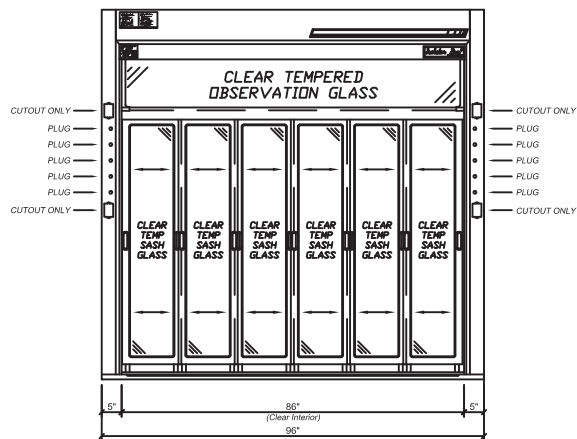

F-292-120G5 - 120" Wide

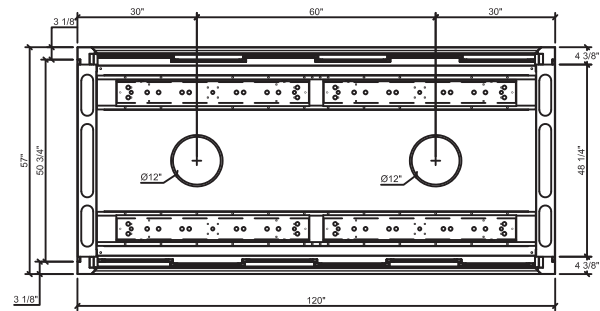
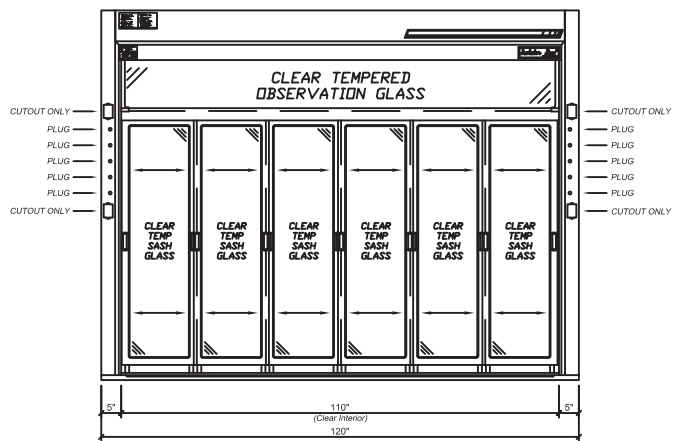

# F-292 Gen-5 Floor Mounted Fume Hood

## F-292-144G5 - 144" Wide

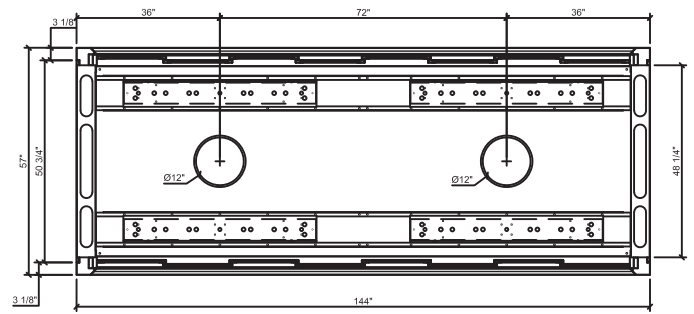
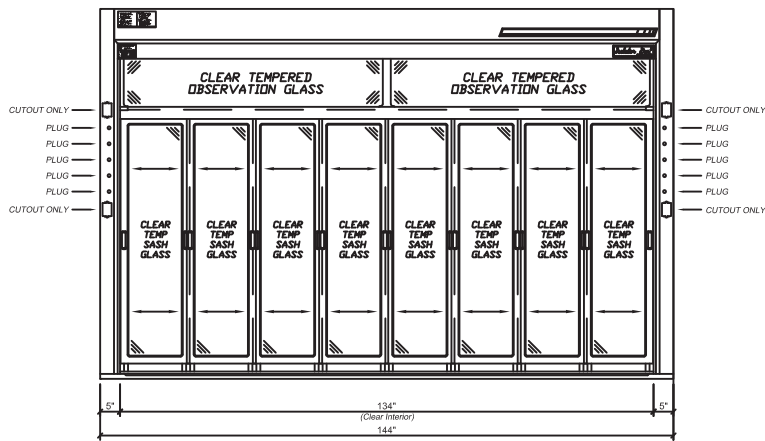

## Section - Double Depth

